

SETUP BEFORE STARTING - EINSTELLUNG VOR DEM START

**Steering and Throttle Reverse Switch
Servo Reverse Schalter**
Servo Factory Settings
Beachten Sie die Pfeile für die Servo Grundeinstellung

**Binding Button
Binding Taster**
The other side Rückseite

**ST.D/R
Steering Dual Rate
Maximaler Lenkausschlag**

To be used to adjust steering servo rate and range.
Einstellung des maximalen Lenkausschlages.

**Battery Level Indicator
Batterie Statusanzeige**

● ● ● ● Good Batteries
Volle Batterien

● ● ● ✱ Low Batteries
Fast leere Batterien

When the batteries are low the green indicator light will flash.

**Throttle Trim
Gastrimmung**
To be used for trimming the throttle operation.
Wird verwendet um den Gasnullpunkt einzustellen.

Antenna/Antenne
Flip the antenna up before use

**Steering Trim
Lenktrimmung**
To be used for trimming the steering operation.
Wird verwendet, um den Geradeauslauf einzustellen.

**Steering Wheel
Lenkrad**
To be used for steering operation.
Wird verwendet um das Fahrzeug zu steuern.

**Charger plug in
Ladebuchse**

※ Rechargeable AA batteries required.
Charger not included. Nutzen Sie diese Ladebuchse nur mit aufladbaren Batterien.

**Power Switch
Ein/Aus Schalter**

RADIO BINDING INSTRUCTIONS

The radio system is bound from the factory so no binding should be necessary. However, if you are matching a new receiver to the transmitter, please follow these steps:

1. Install AA batteries into the transmitter.
2. Insert the binding plug into CH 3 port on the receiver. (Figure 1)
3. Turn on the receiver. You will notice the two LED's are now flashing meaning the receiver is in 'seek' mode and ready to find the transmitter.
4. Press and hold the binding button on the transmitter while turning on the power switch. (Figure 2)
5. The LED's on the receiver should stop flashing indicating it's now bound to the transmitter.
6. Release the binding button on the transmitter and remove the binding plug from the receiver.
7. Turn off the receiver, then turn off the transmitter. Once powered on again, radio binding has been completed.

If the system did not bind please repeat step's 1-7 again or call Axial Customer Service: (949) 600-8642. NOTE: the AX-3 transmitter will only bind with the AR-3 receiver

Fail Safe Programming

1. With the radio system bound and powered up, position the throttle trigger to the stop position. For electric applications with drag brake, put the trigger in the stop position. For Nitro applications, position the throttle to apply some amount of brake.
2. With the throttle trigger positioned to desired fail safe position press and hold the button on the receiver until the red LED starts flashing. As soon as it starts flashing release the button; it will then flash for 3 more seconds. Fail safe is now programmed.
3. To test, elevate your vehicle so the tires are off the ground. Apply some throttle and turn the transmitter off. If the throttle returns to neutral within a few seconds, fail safe is programmed correctly. If your vehicle keeps running, fail safe was not programmed correctly; repeat steps 1 and 2.

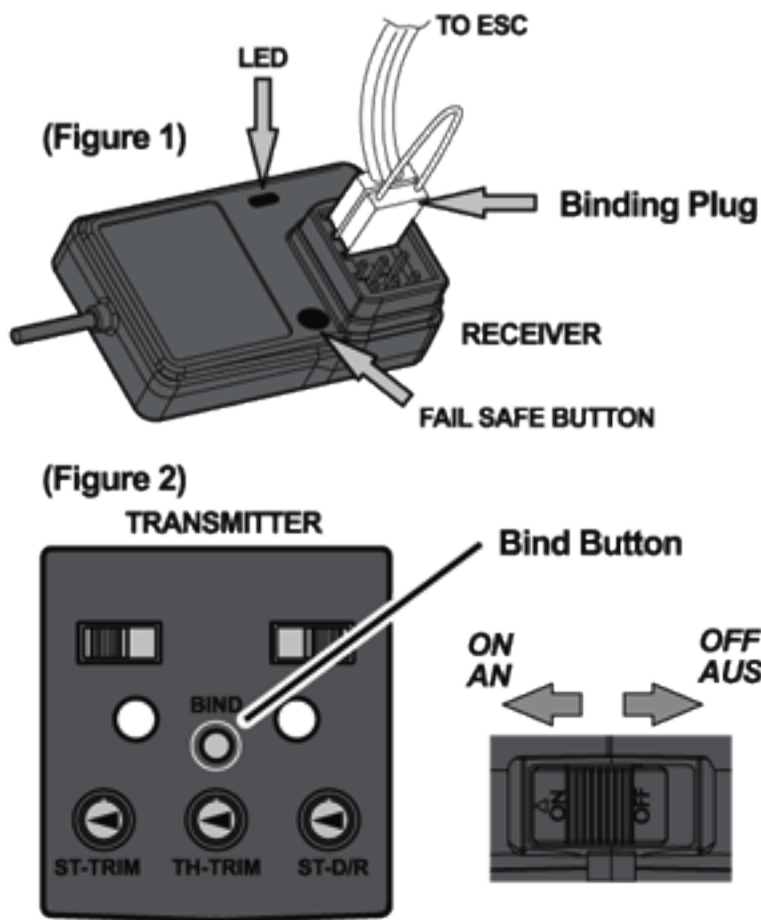

**Battery Cover
Batteriefach**

4X AA alkaline batteries
4X Pilas alcalinas AA

Transmitter Battery Installation/Einglegen der Senderbatterien
Open battery cover at bottom of transmitter. Install batteries. Follow the direction of batteries designated in the inside of battery box.
Öffnen Sie das Batteriefach an der Unterseite des Senders. Legen Sie die Batterien entsprechende der angegebenen Polarität ein.

ATTENTION
Do not mix batteries of different ages or types.
Mischen Sie keine Batterien verschiedenen Typs oder Alters.

CAUTION

- NEVER RUN R/C MODEL IN CROWDED AREA OR NEAR SMALL CHILDREN
- PROTECT YOUR SYSTEM FROM MOISTURE
- REMOVE BATTERY FROM R/C MODEL WHEN STORING