

MST

MAX SPEED TECHNOLOGY

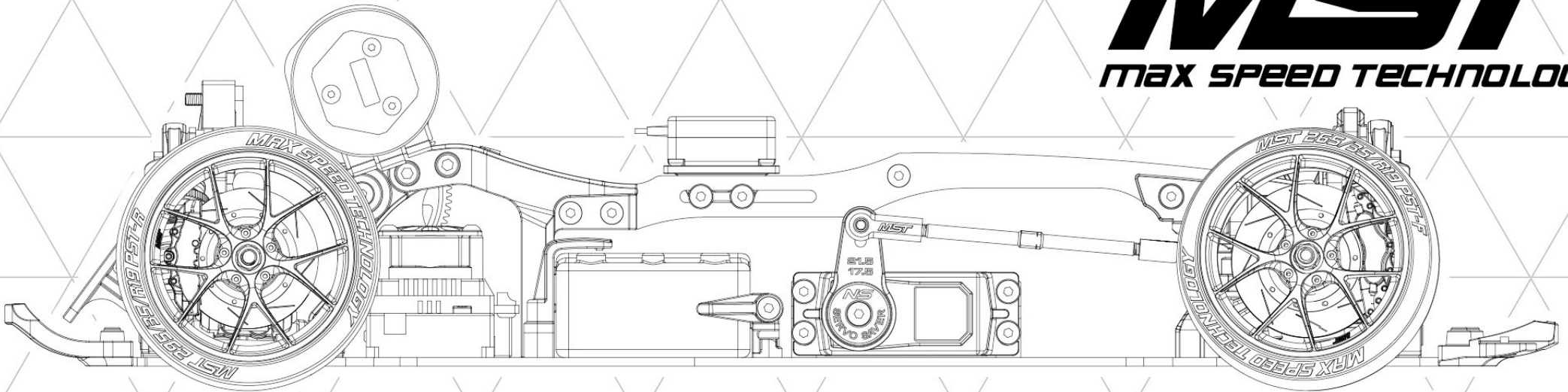

RMX EX S PRO

1/10 SCALE RC RWD HIGH PERFORMANCE DRIFT CAR

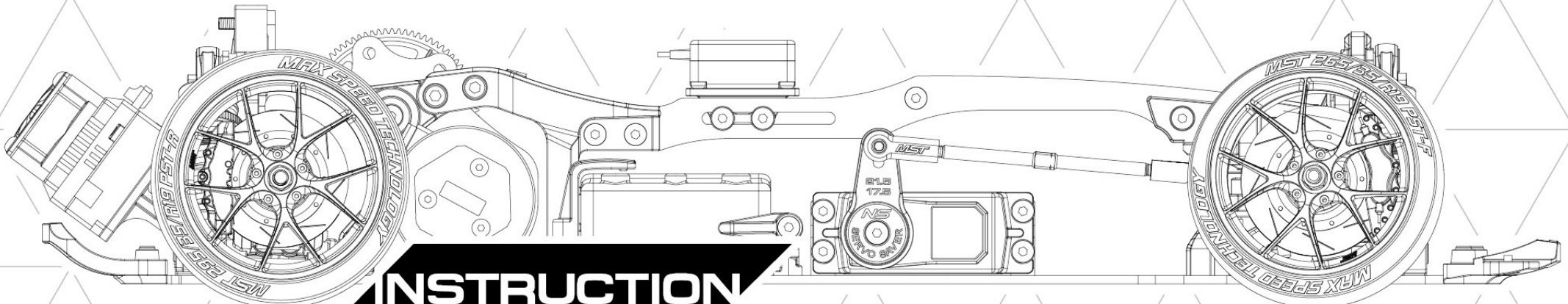

INSTRUCTION MANUAL

ON ROAD USE ONLY

SPECIFICATION: 1:10 Drift Car
WHEELBASE: 210.225.233.239.245mm
WIDTH: 164mm
DRIVE MODE: RWD
CASTER: Adjustable 6/ 8/ 10/ 12 degrees
CAMBER: Adjustable 0 to -12 degrees
FULL BALL BEARING
HYDRAULIC DAMPER SET



ASSEMBLY KIT

www.rc-mst.com

* SPECIFICATION ARE SUBJECT TO CHANGE WITHOUT NOTICE

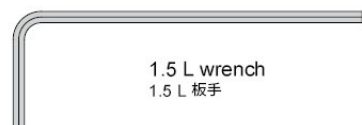

1.5 L wrench
1.5 L 板手



2.0 L wrench
2.0 L 板手

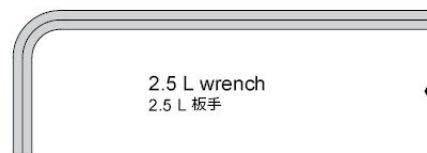

2.5 L wrench
2.5 L 板手

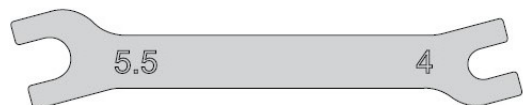

5.5 x 4.0 wrench
5.5 x 4.0 板手



5.5 & 7.0 alum. wrench
5.5 & 7.0 套筒板手

Please follow the assembling figures and instructions closely for your [RMX EX S PRO] best performance!
 請依照說明書圖示步驟安裝以發揮 [RMX EX S PRO] 最好效能!

NECESSARY TOOLS FOR ASSEMBLY 工具需求 (NOT INCLUDED IN KIT) [另購]



Hobby knife
美工刀

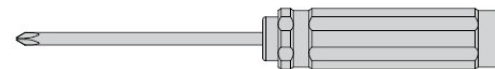

Screwdriver
螺絲起子

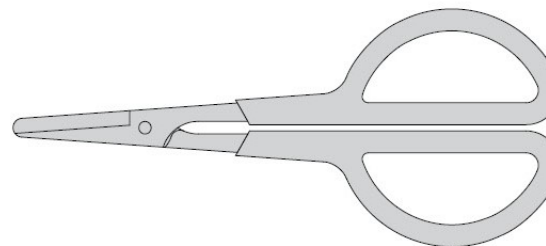

Scissors
剪刀

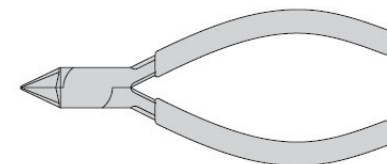

Side cutter
斜口鉗

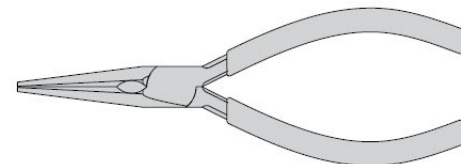

Needle nose pliers
尖嘴鉗

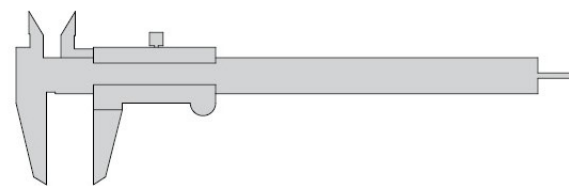

Vernier caliper
游標卡尺

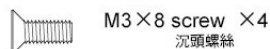
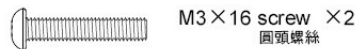
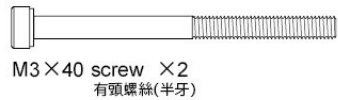
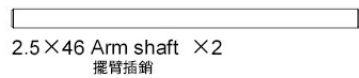
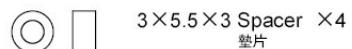
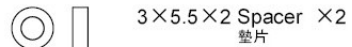
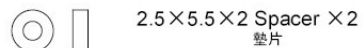
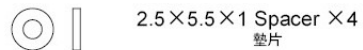
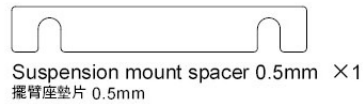
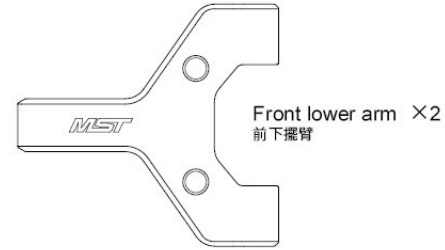

STEP 1 Front lower arm assembly
前下擺臂組裝

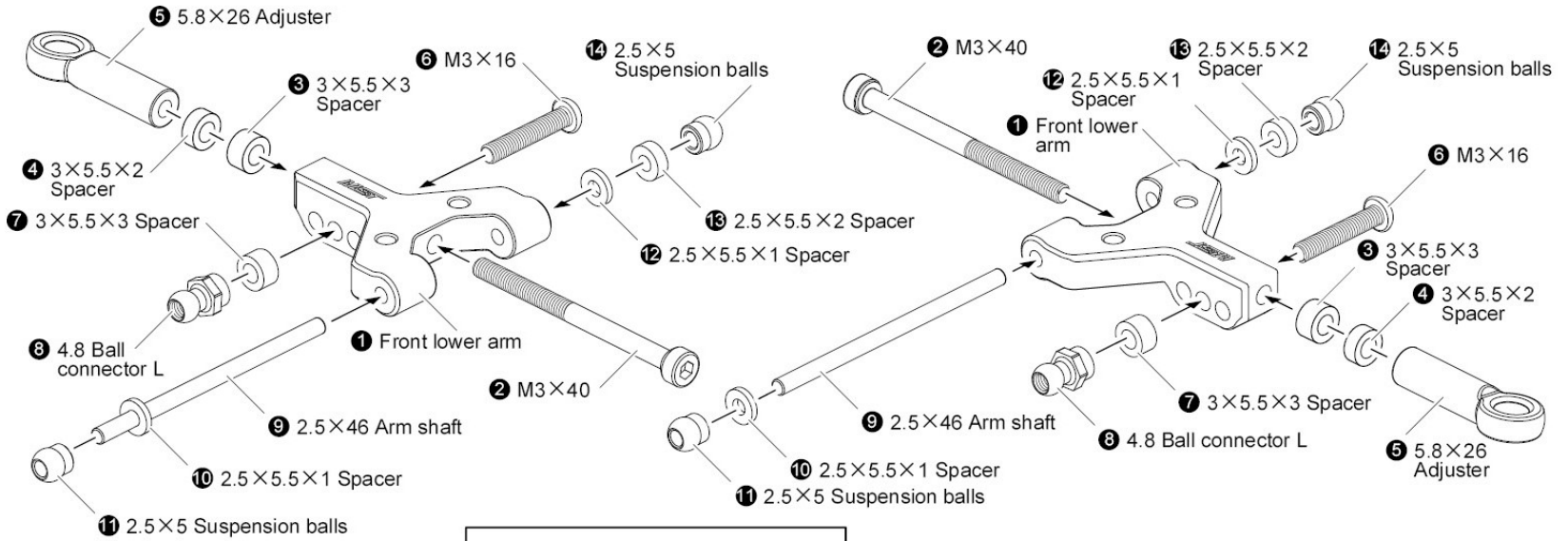

STEP 2 Attaching front lower arm
安裝前下擺臂

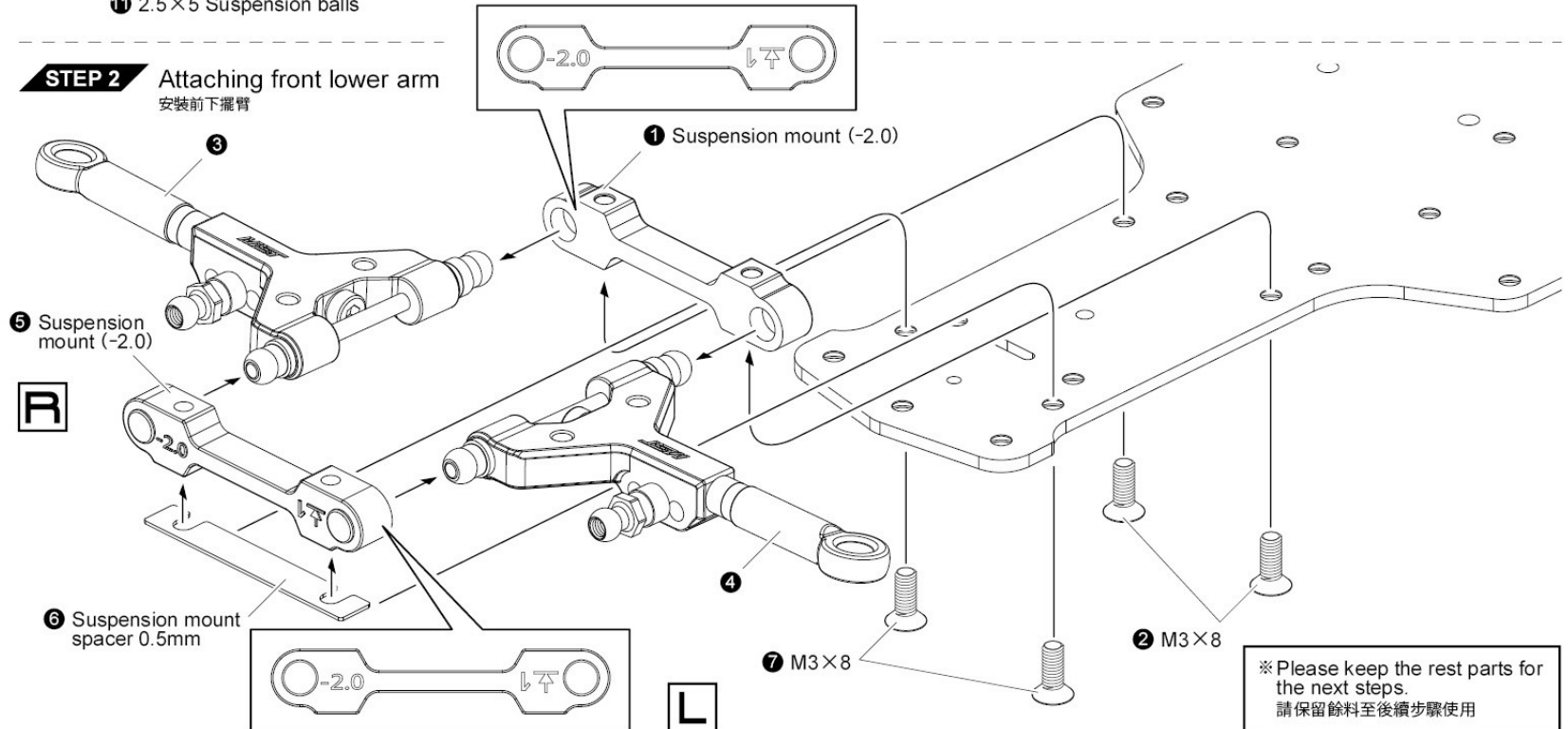

※ Please keep the rest parts for the next steps.
請保留餘料至後續步驟使用

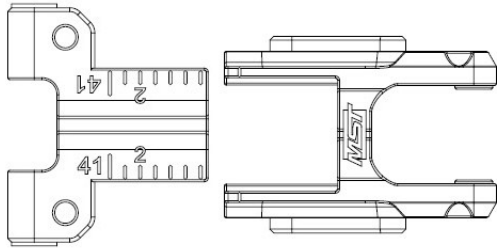

Rear lower arm A ×2
後下擺臂 A

Rear lower arm B ×2
後下擺臂 B



Suspension mount (+12) ×1
下擺臂座 (+12)



Suspension mount (+13) ×1
下擺臂座 (+13)



Suspension mount spacer 0.5mm ×2
擺臂座墊片 0.5mm

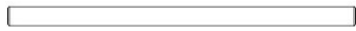

2.5×46 Arm shaft ×2
擺臂插銷



2.5×5 Suspension balls ×4
懸吊球頭

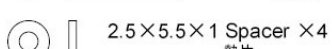

4×15 Strengthen post ×2
補強柱



2.5×5.5×1 Spacer ×4
墊片

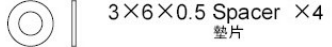

2.5×5.5×2 Spacer ×2
墊片



3×5.5×3 Alum. spacer ×8
鋁合金墊片

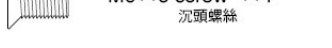

3×6×0.5 Spacer ×4
墊片

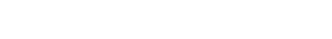

M2×8 screw ×4
圓頭螺絲

M3×20 screw ×4
圓頭螺絲

M3×8 screw ×4
沉頭螺絲

4.8×4.5 Ball connector ×2
球頭螺絲

STEP 1 Rear lower arm assembly
後下擺臂組裝

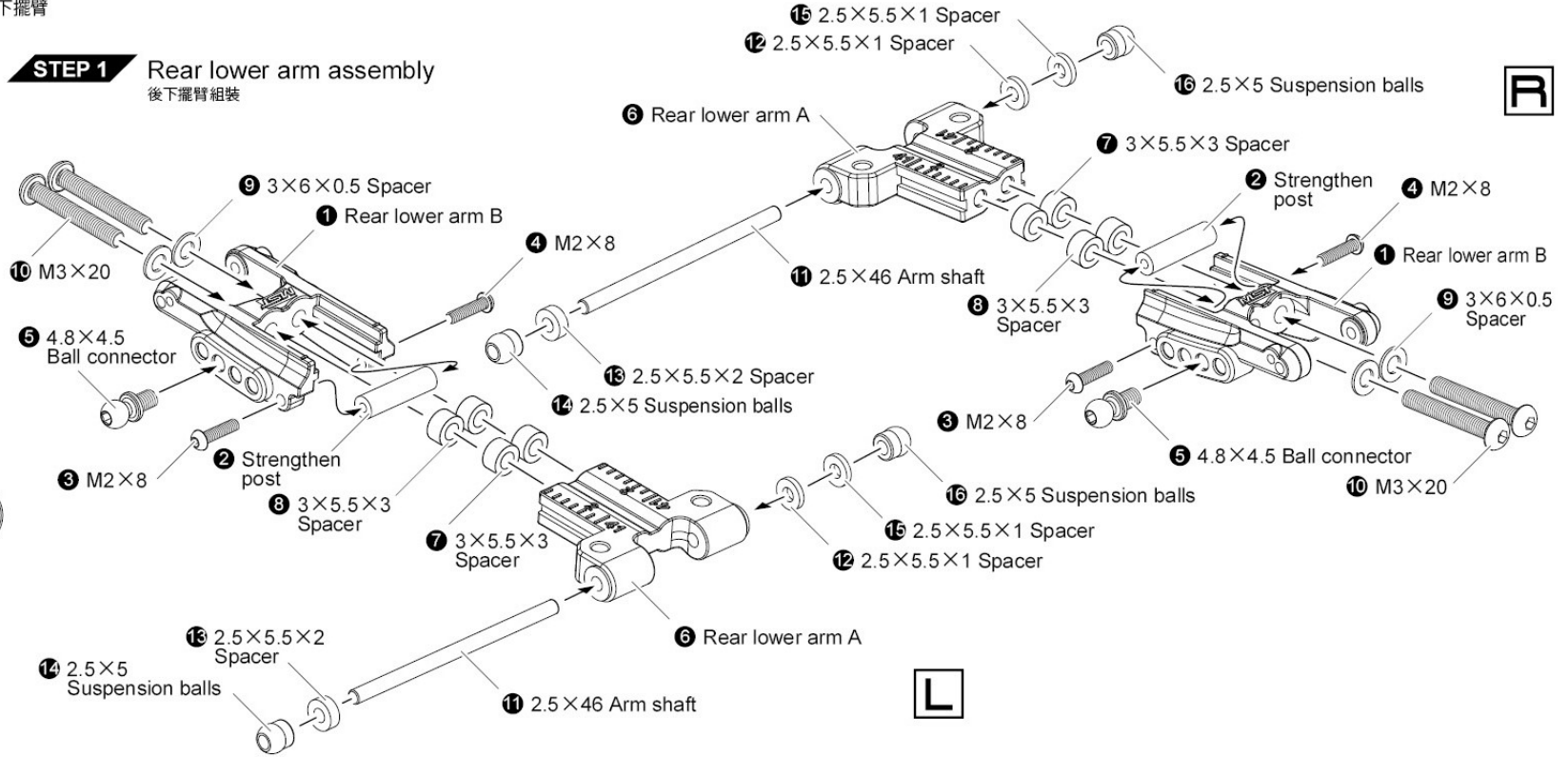

STEP 2 Attaching rear lower arm
安裝後下擺臂

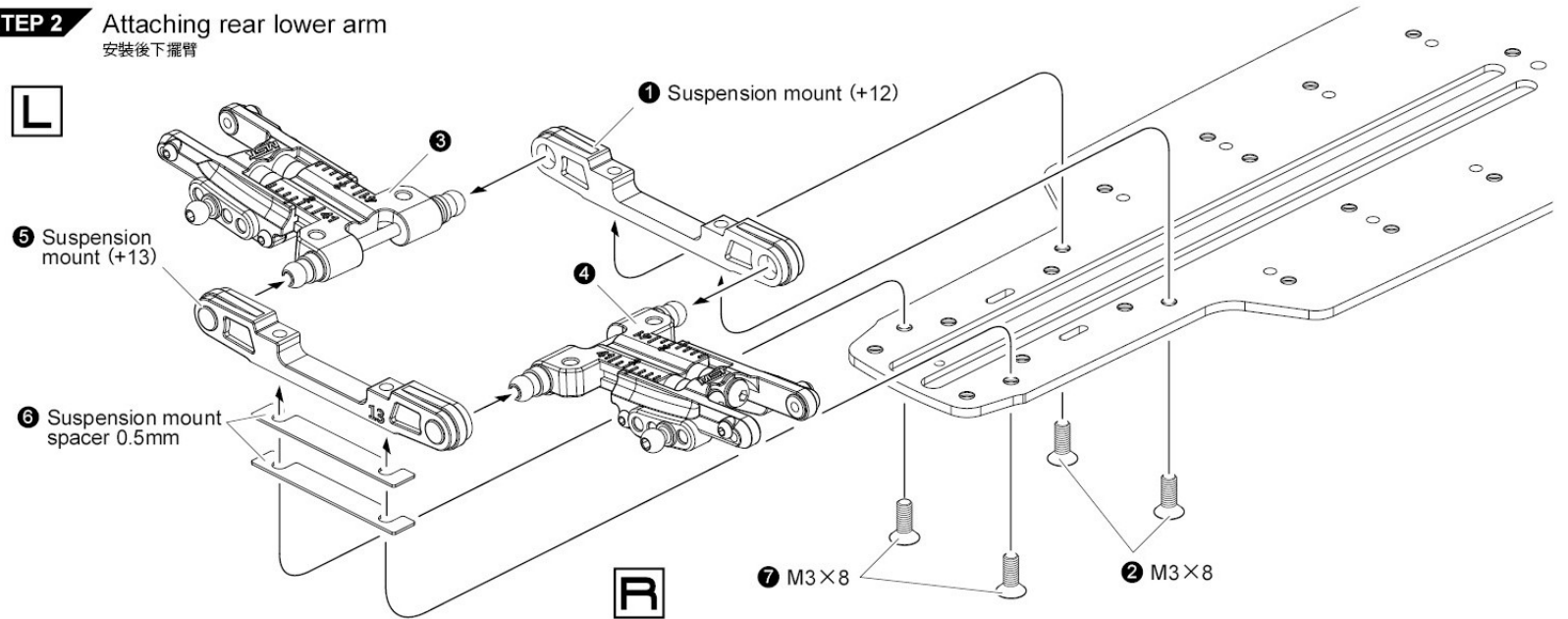

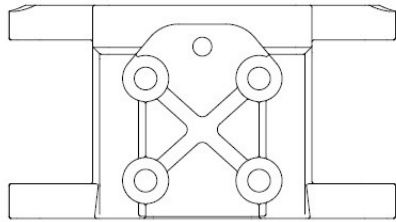
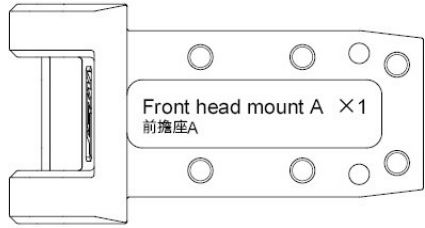

Front upper arm mount × 1
前上擺臂座

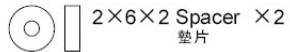
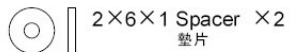
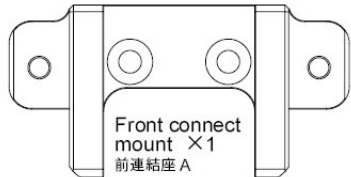

Front upper arm × 2
前上擺臂

Bag 1



M3×25 steel turnbuckle × 2
鋼製可調拉桿



2×28 shaft × 2
插銷

STEP 1 Front upper arm assembly
前上擺臂組裝

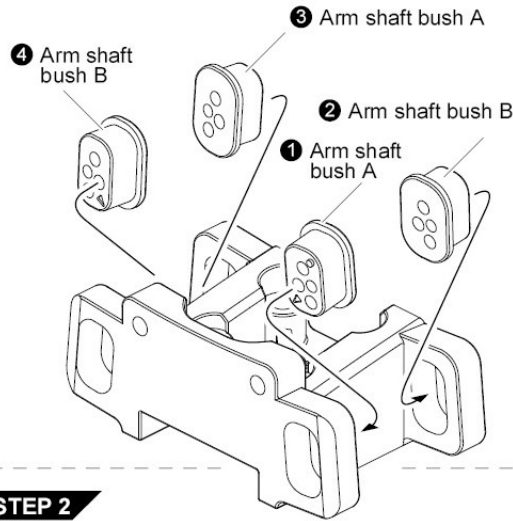

STEP 2

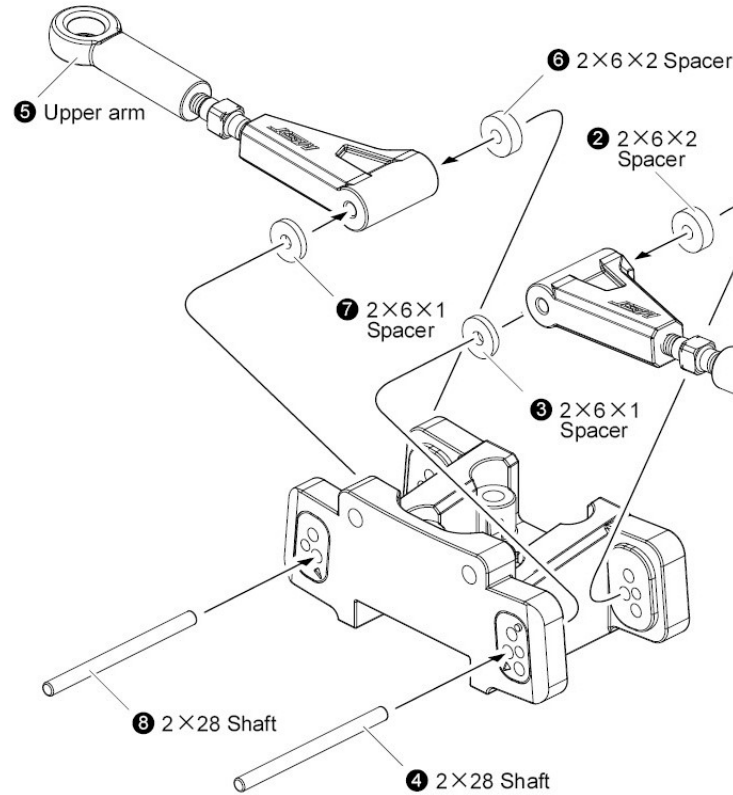

X2
Make 2

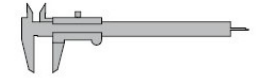
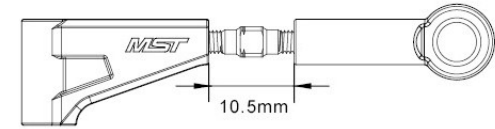
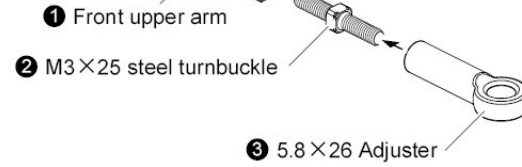

※ Please use a caliper for precise measurements.
請使用卡尺進行精確測量

STEP 3

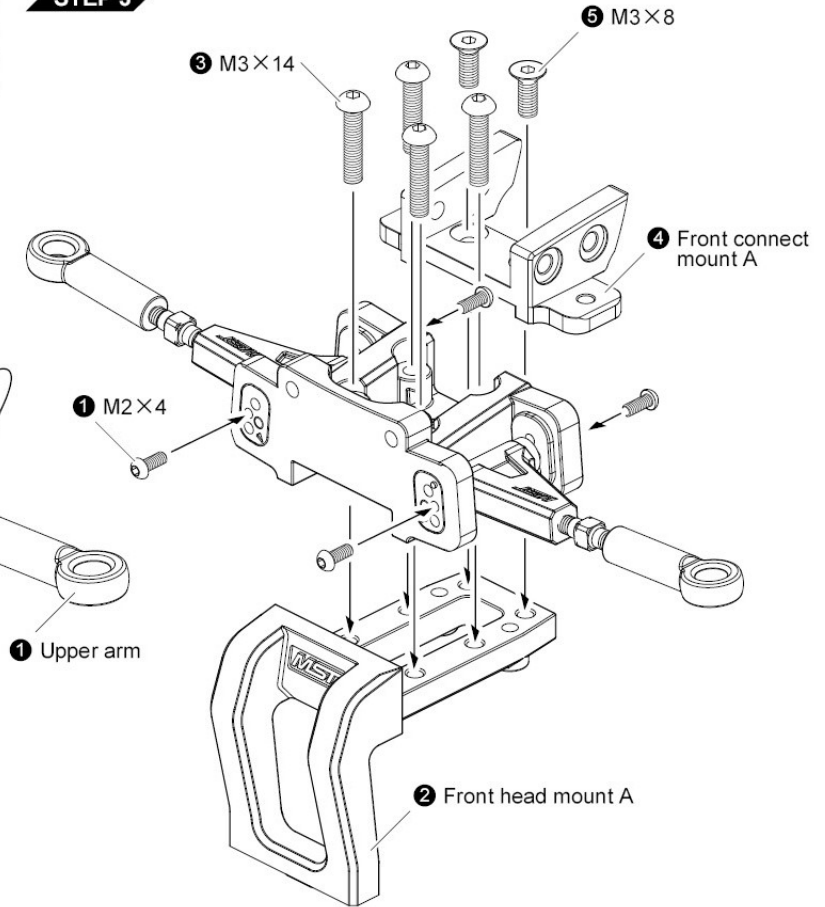

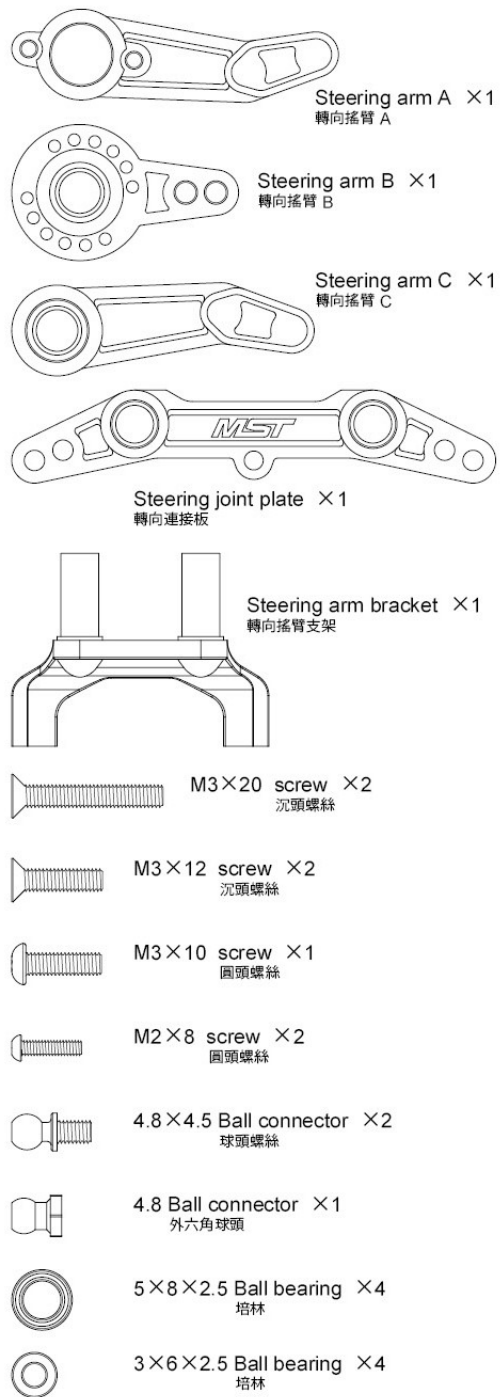

STEP 1 Steering arm assembly

轉向搖臂組裝

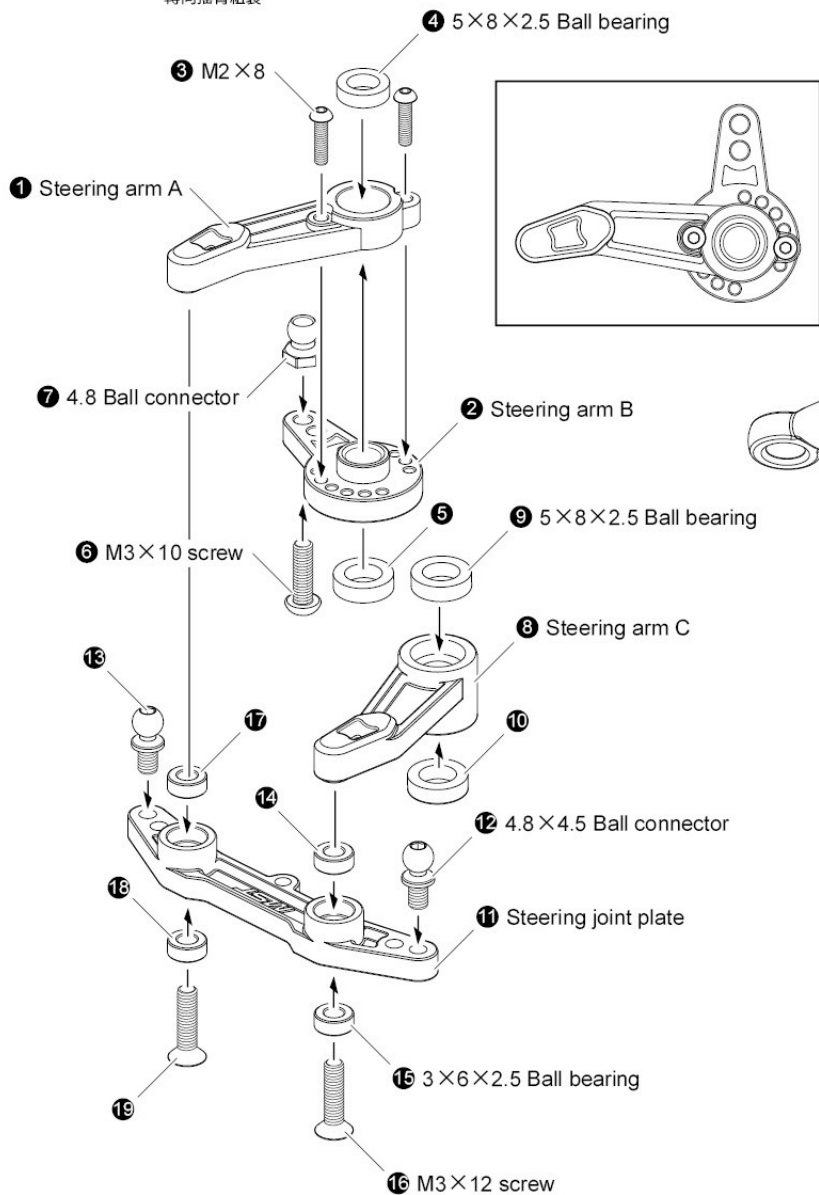

STEP 2 Attaching steering arm

安裝轉向搖臂組

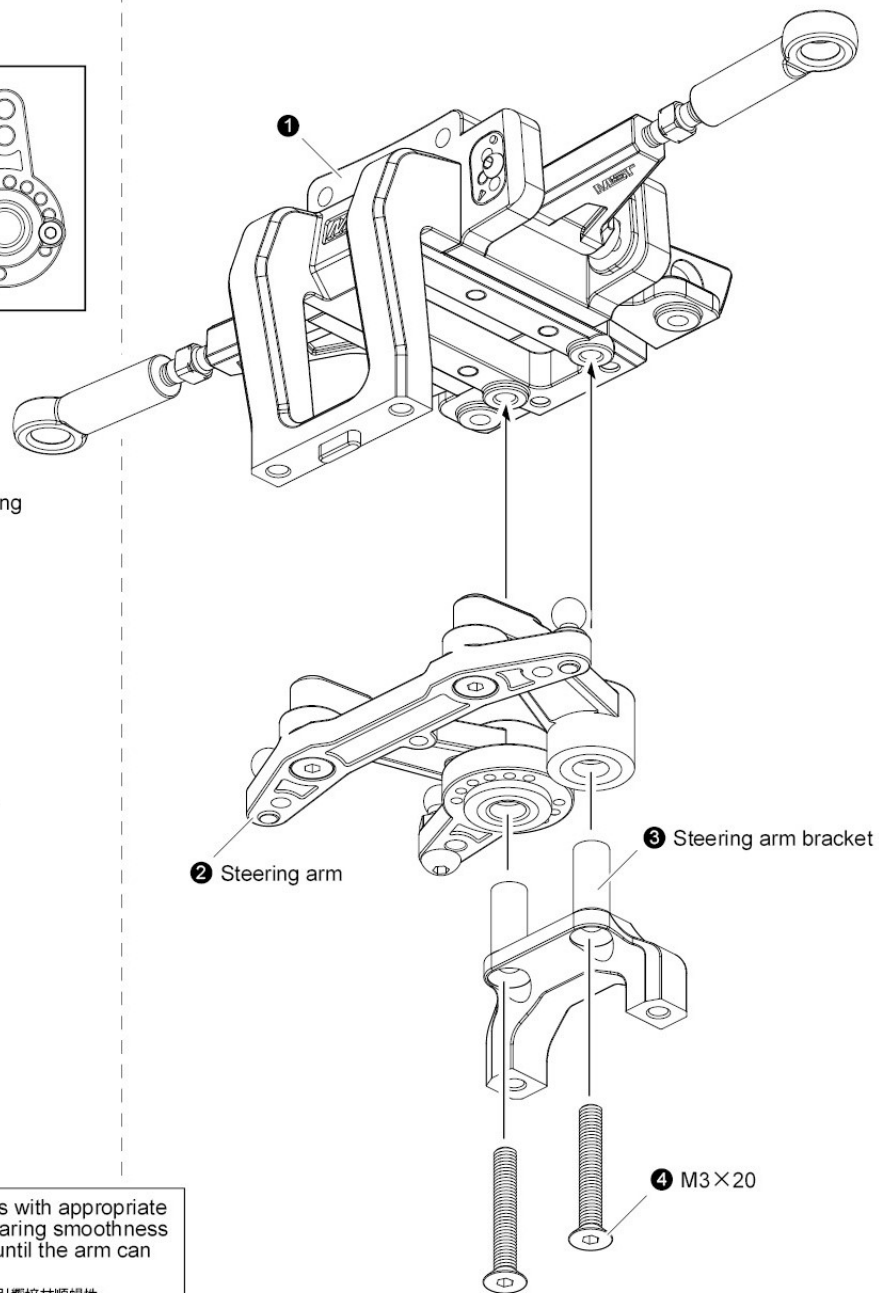

⚠ Please tighten the M3×12 screws with appropriate force. If it is overtightened, the bearing smoothness will be affected. Please loosen it until the arm can move smoothly.
M3×12螺絲請以適當力道鎖緊即可,若鎖太緊會影響培林順暢性,請放鬆至搖臂能順暢作動為止!

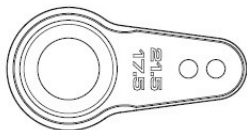

Long servo horn ×1
長伺服片



Servo saver cover ×1
伺服緩衝上蓋



Servo saver mount 23T ×1
23T 伺服緩衝座



Servo saver mount 25T ×1
25T 伺服緩衝座



4.8 Adjuster M ×6
拉桿頭

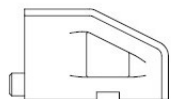

Servo mount ×2
伺服機座



M3×28 Alum. turnbuckle ×2
鋁合金可調拉桿

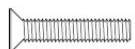

M3×16 screw ×1
沉頭螺絲



M3×8 screw ×4
圓頭螺絲



M3×8 screw ×6
沉頭螺絲



4.8×4.5 Ball connector ×1
球頭螺絲

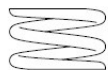

Servo saver spring (Silver) ×1
伺服緩衝彈簧(銀)



3×6×0.5 Spacer ×4
墊片



M3×68 Alum. turnbuckle ×1
鋁合金可調拉桿

STEP 1 Steering servo assembly

轉向伺服機組裝

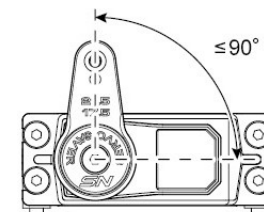
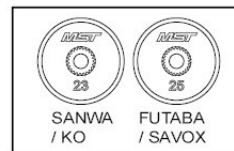
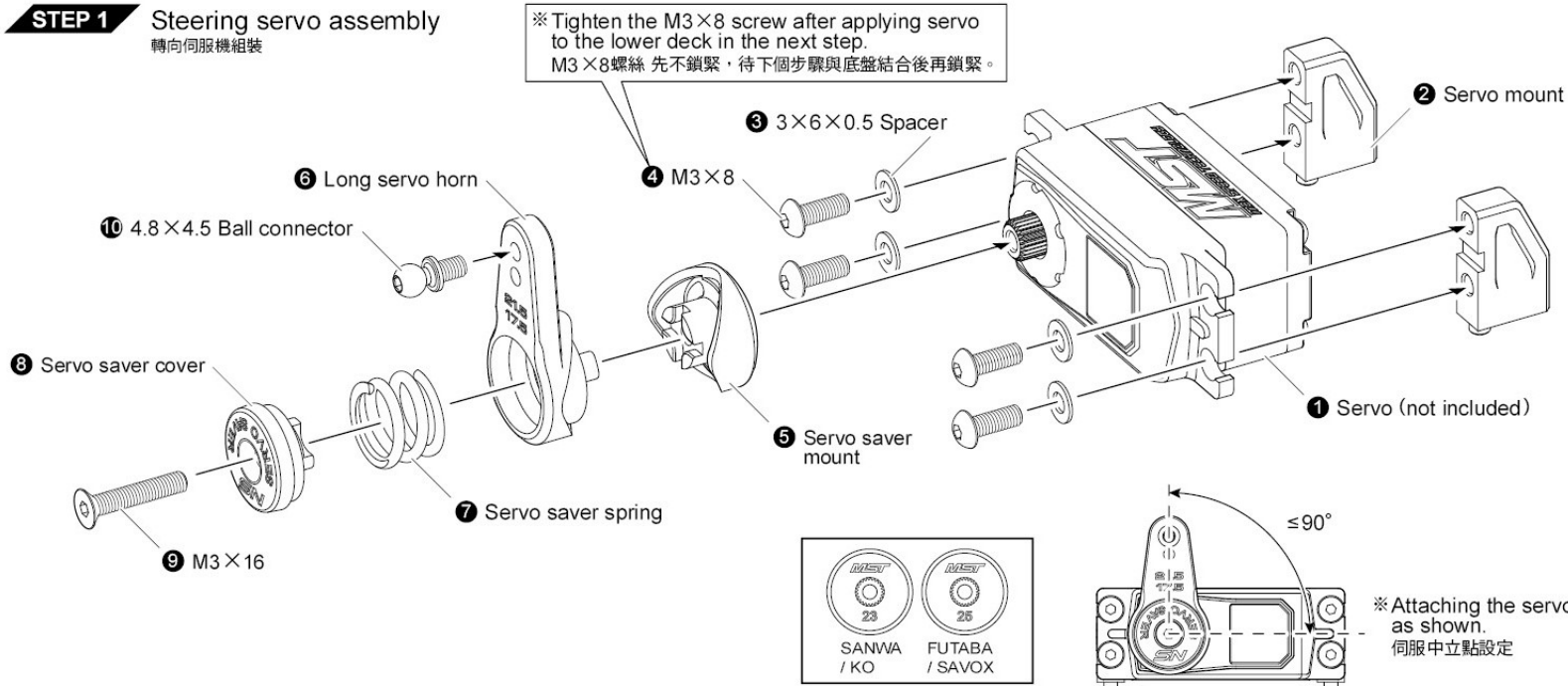

※ Attaching the servo as shown.
伺服中立點設定

STEP 2 Servo saver turnbuckle assembly

伺服拉桿組裝

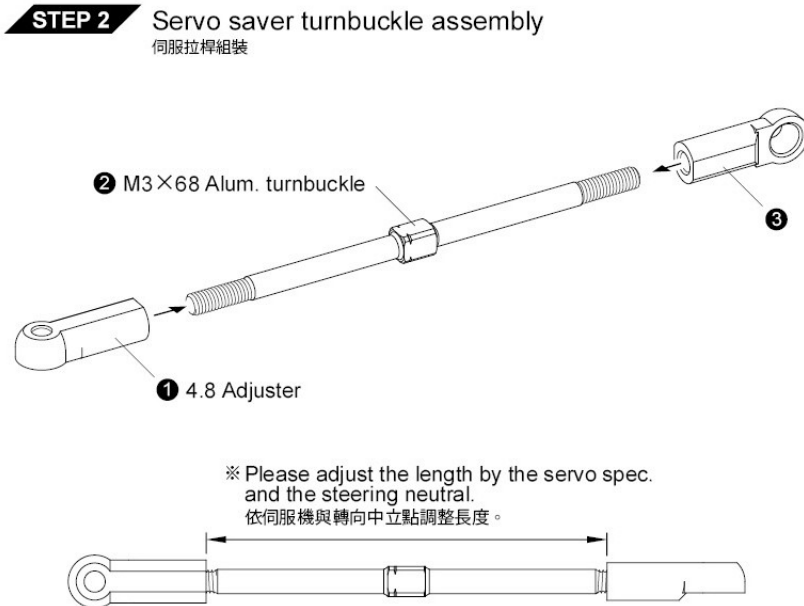

STEP 3 Steering adjuster assembly

轉向拉桿組裝

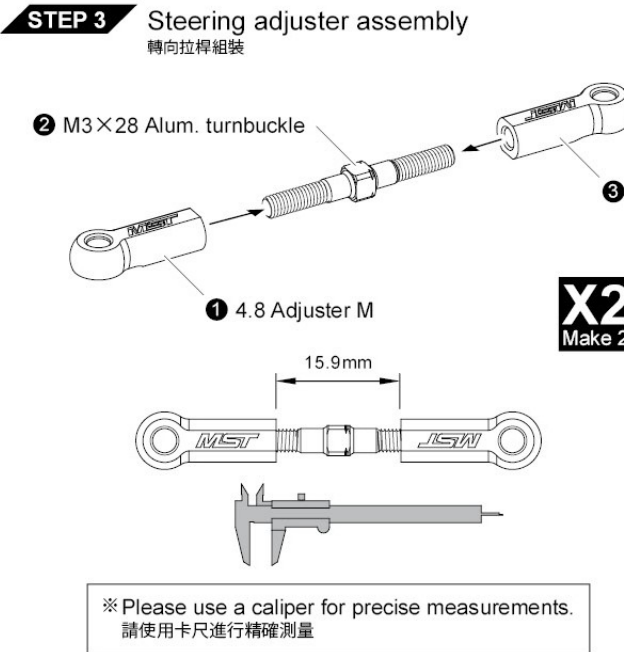

X2
Make 2

STEP 1 Attaching front steering-suspension
安裝前擔組

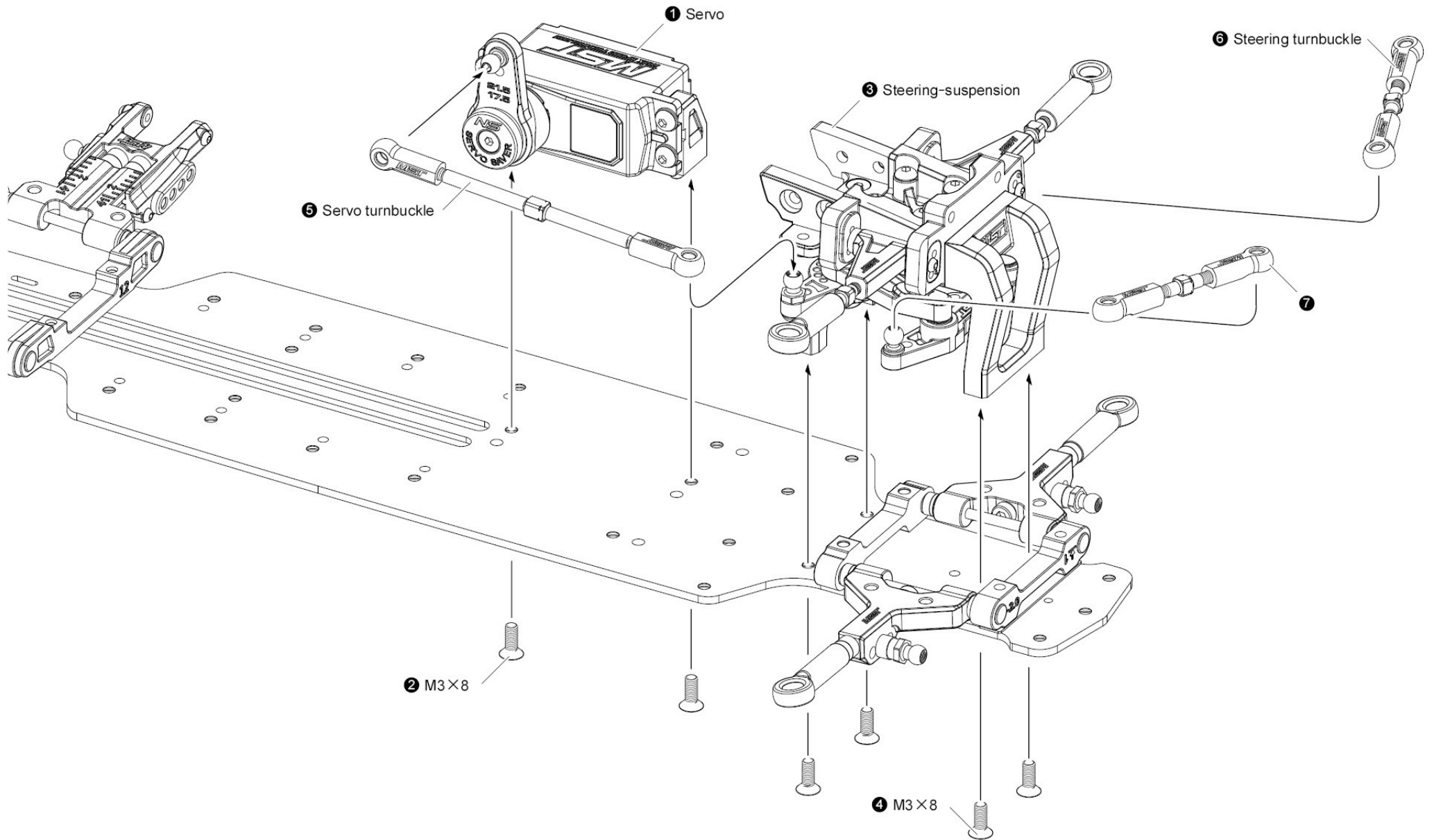

STEP 1 Attaching upper deck
安裝二樓板

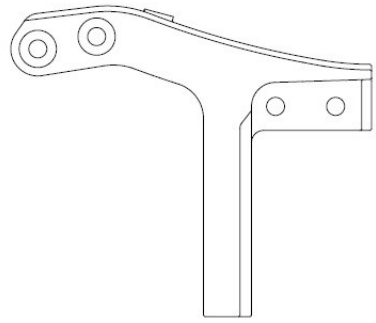

Gear box connector A ×1
連結架 A

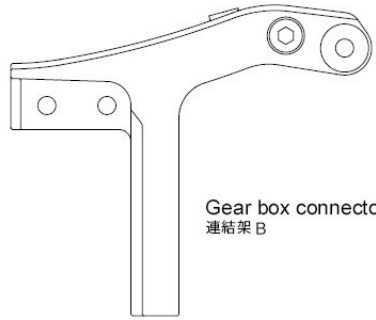

Gear box connector B ×1
連結架 B



Strengthen post ×1
補強柱

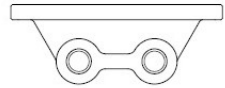

Gyro mount ×1
陀螺儀座

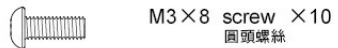

M3×8 screw ×10
圓頭螺絲

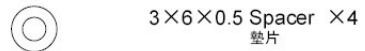

3×6×0.5 Spacer ×4
墊片

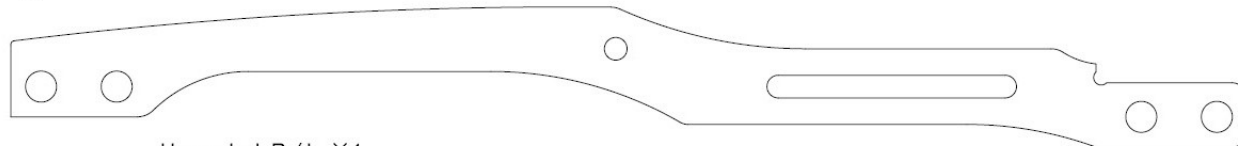

Upper deck R / L ×1
二樓板 R / L

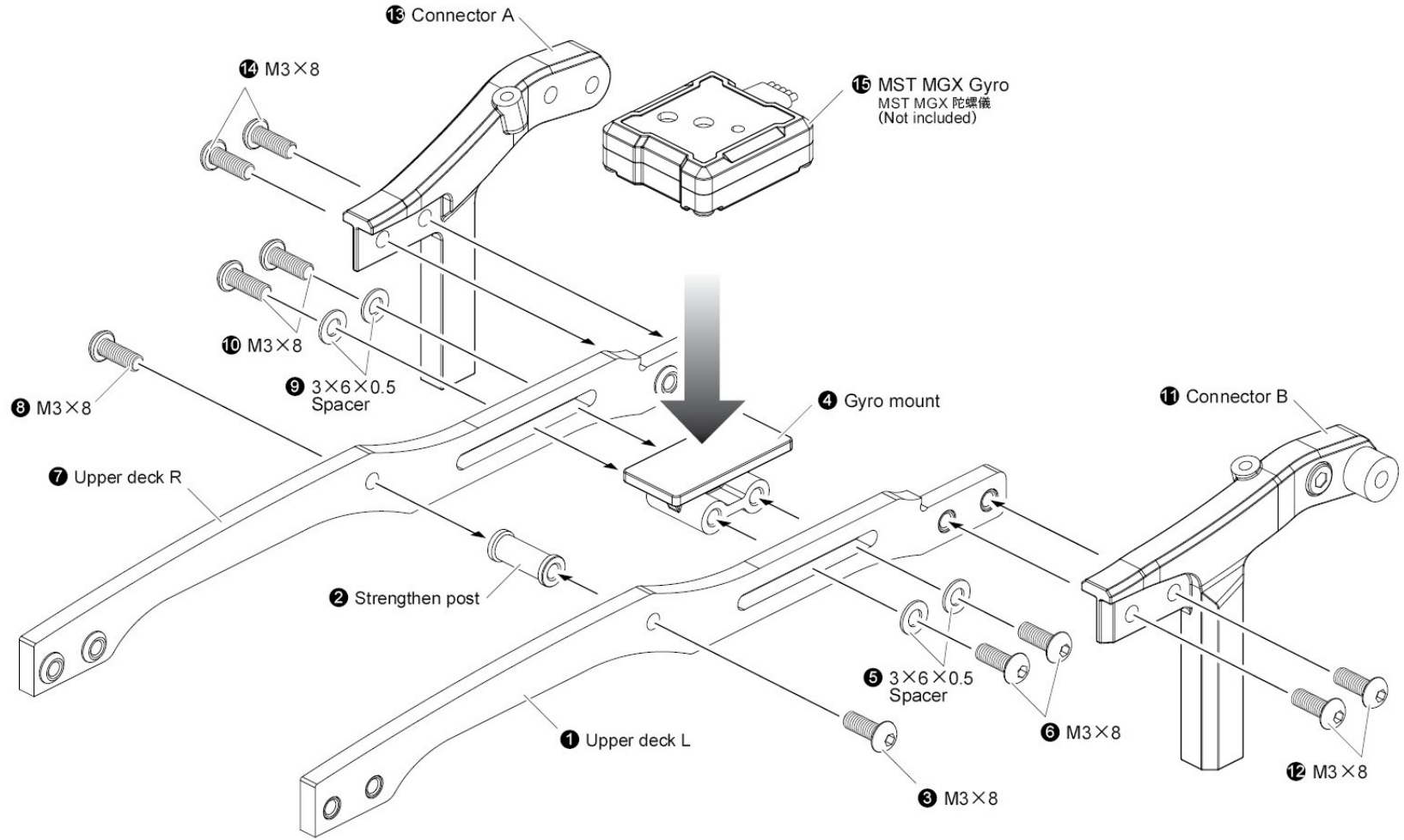
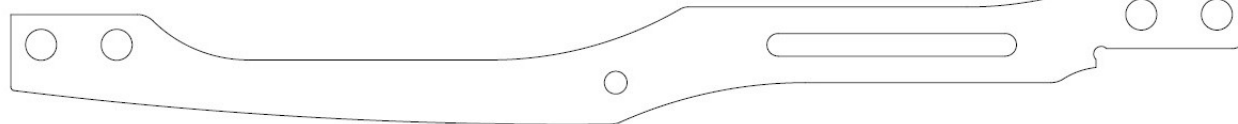

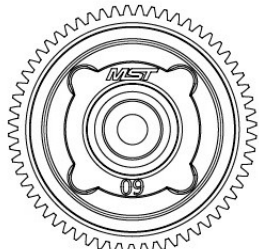

Differential gear 60T ×1
傘差60T

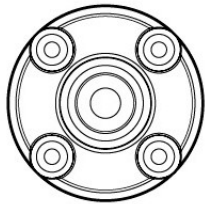

Diff. case cover ×1
傘差齒蓋



Bevel gear 14T ×2
傘齒 14T

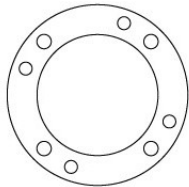

Spacer ×1
止漏墊片



Bevel gear 10T ×4
傘齒 10T

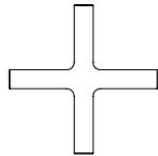

Star shaft ×1
十字銷

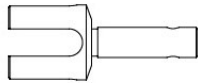

Diff. joint ×2
傘差接杯



10×15 Ball bearing ×2
培林

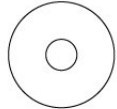

4×14×0.1 Spacer ×2
墊片



2.5×9×0.1 Spacer ×4
墊片



P4 O-ring ×2
O環

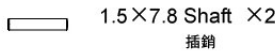

1.5×7.8 Shaft ×2
插銷



4×8×3 Spacer ×2
墊片

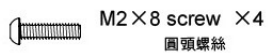

M2×8 screw ×4
圓頭螺絲

STEP 1 Rear diff. set assembly
後滾差組裝

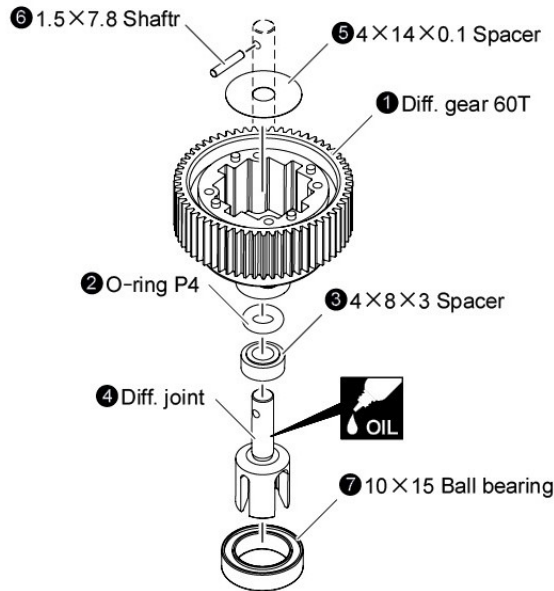

STEP 2

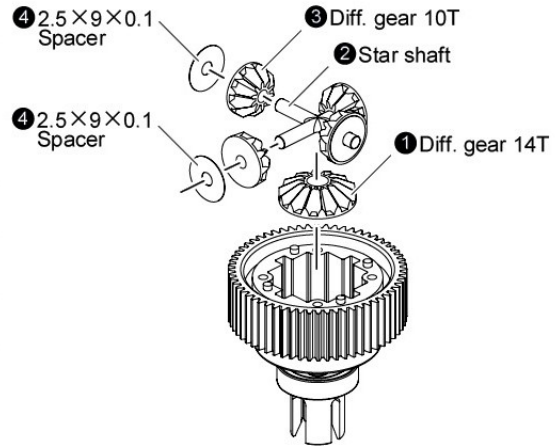

STEP 3

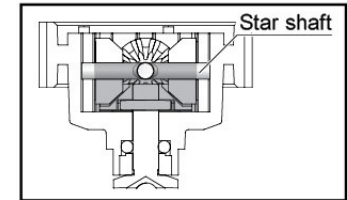

※ Fill with oil up to the level of Star shaft.
(Do not fill the diff. to the top)
請填入差速油至完全覆蓋Star shaft。(勿填滿)

STEP 4

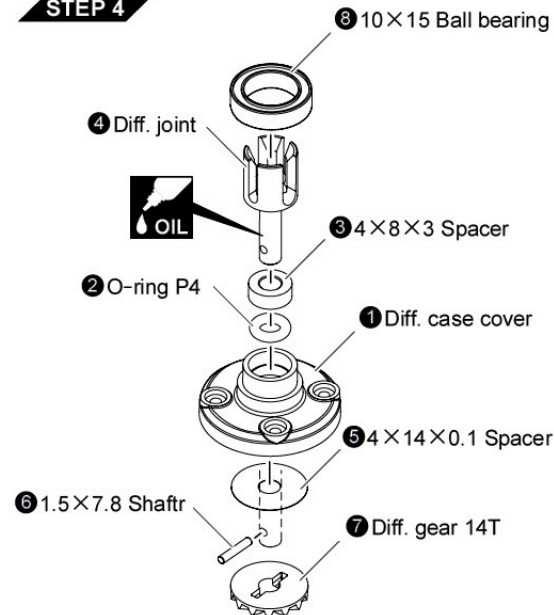

STEP 5

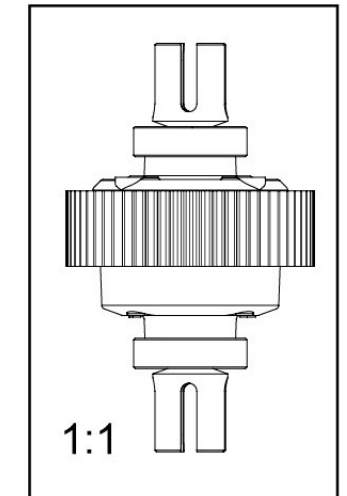
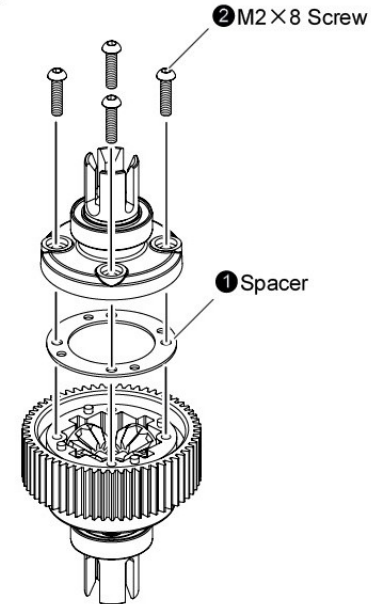

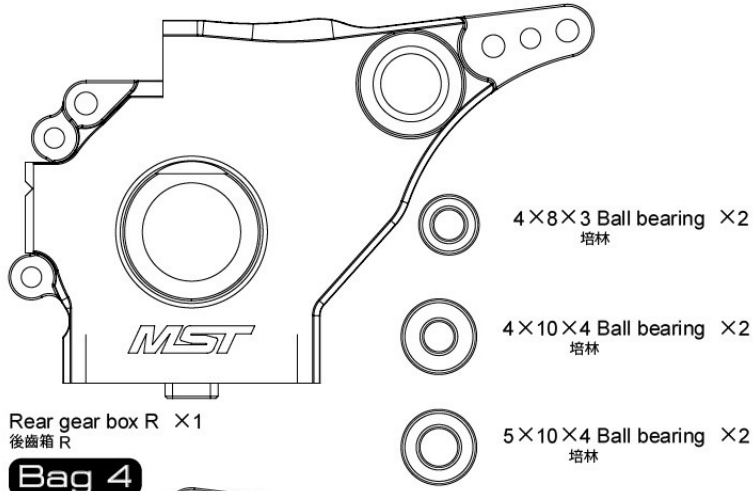

Bag 4

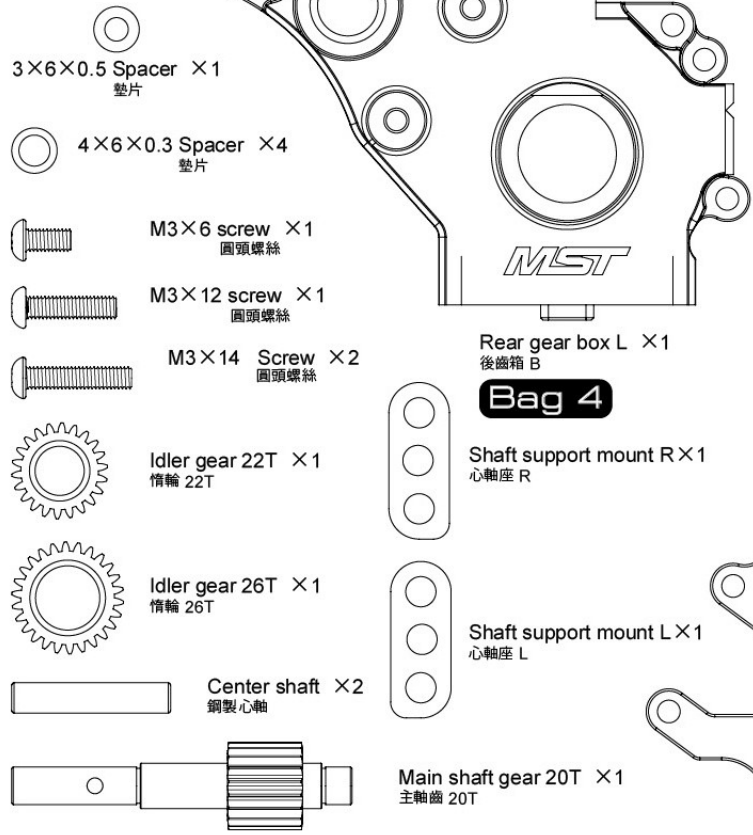

Bag 4

STEP 1 Shaft support mount assembly
心軸座組裝

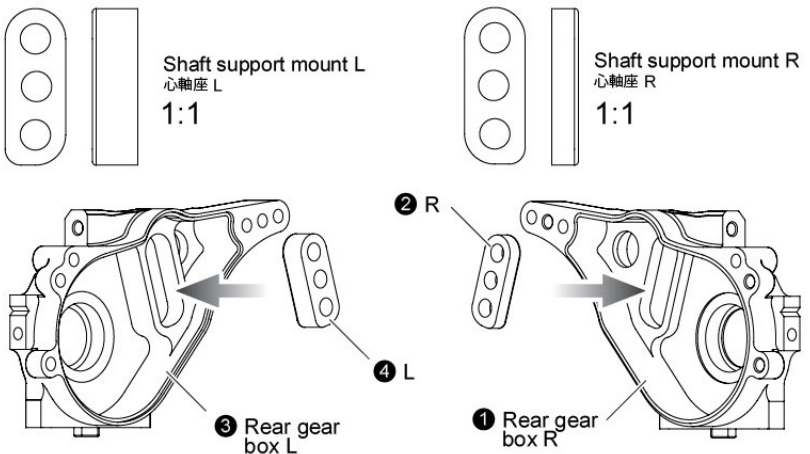

STEP 2 Idler gear assembly
惰輪組裝

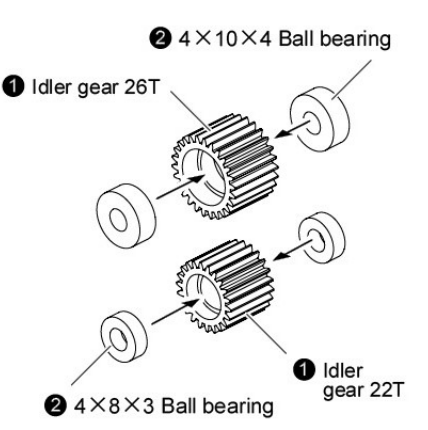

STEP 3 Rear gear box assembly
後齒軸組裝

RRX Mode RRX模式
Please refer to P27 for RRX assembly.
RRX組裝請參閱P27。

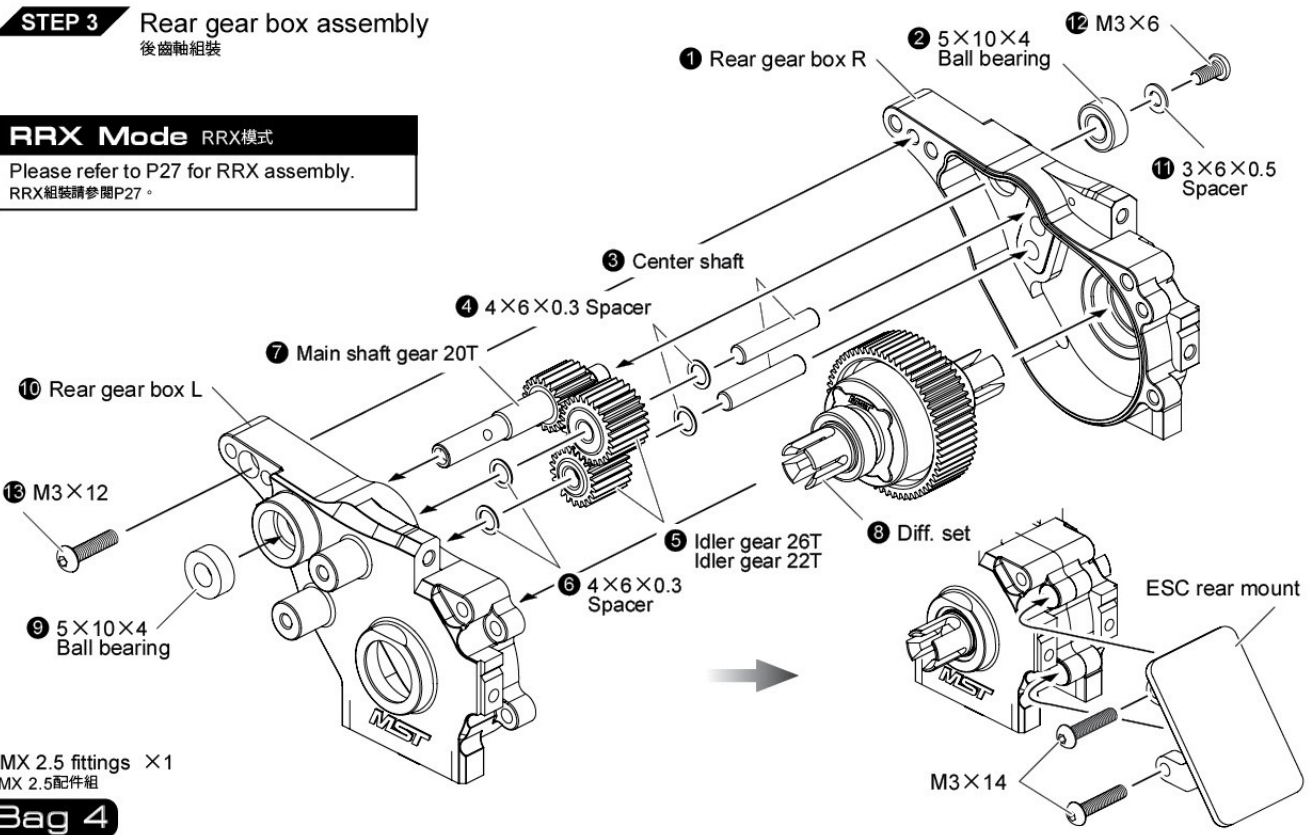

RMX 2.5 fittings ×1
RMX 2.5配件組

Bag 4

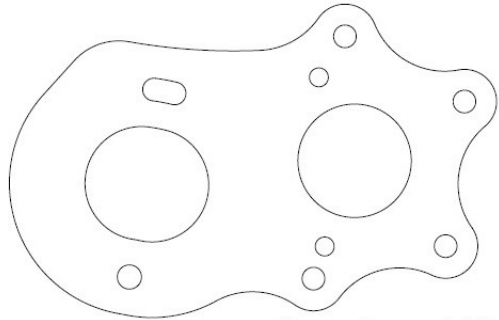

Alum. motor mount ×1
鋁合金馬達座

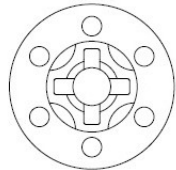

Spur gear holder ×1
大齒盤座

Bag 4

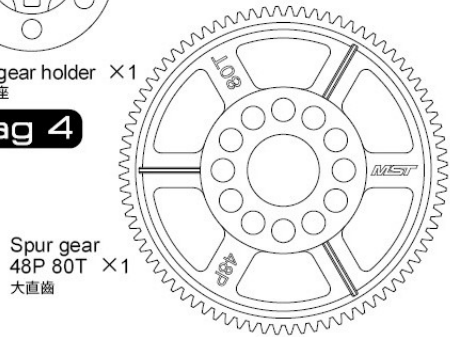

Spur gear 48P 80T ×1
大直齒

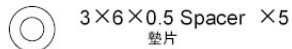

3×6×0.5 Spacer ×5
墊片

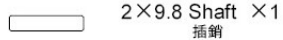

2×9.8 Shaft ×1
插銷

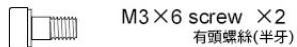

M3×6 screw ×2
有頭螺絲(半牙)

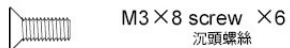

M3×8 screw ×6
沉頭螺絲

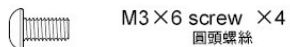

M3×6 screw ×4
圓頭螺絲

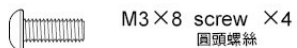

M3×8 screw ×4
圓頭螺絲

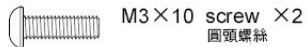

M3×10 screw ×2
圓頭螺絲



M3×30 screw ×1
有頭螺絲(半牙)



M3×40 screw ×1
有頭螺絲(半牙)

STEP 1 Attaching spur gear
安裝大齒盤

※ The spacers are removable when the gear gap is too small.
此墊片為調整主齒軸傘齒間隙用，如傳動偏緊可移除。

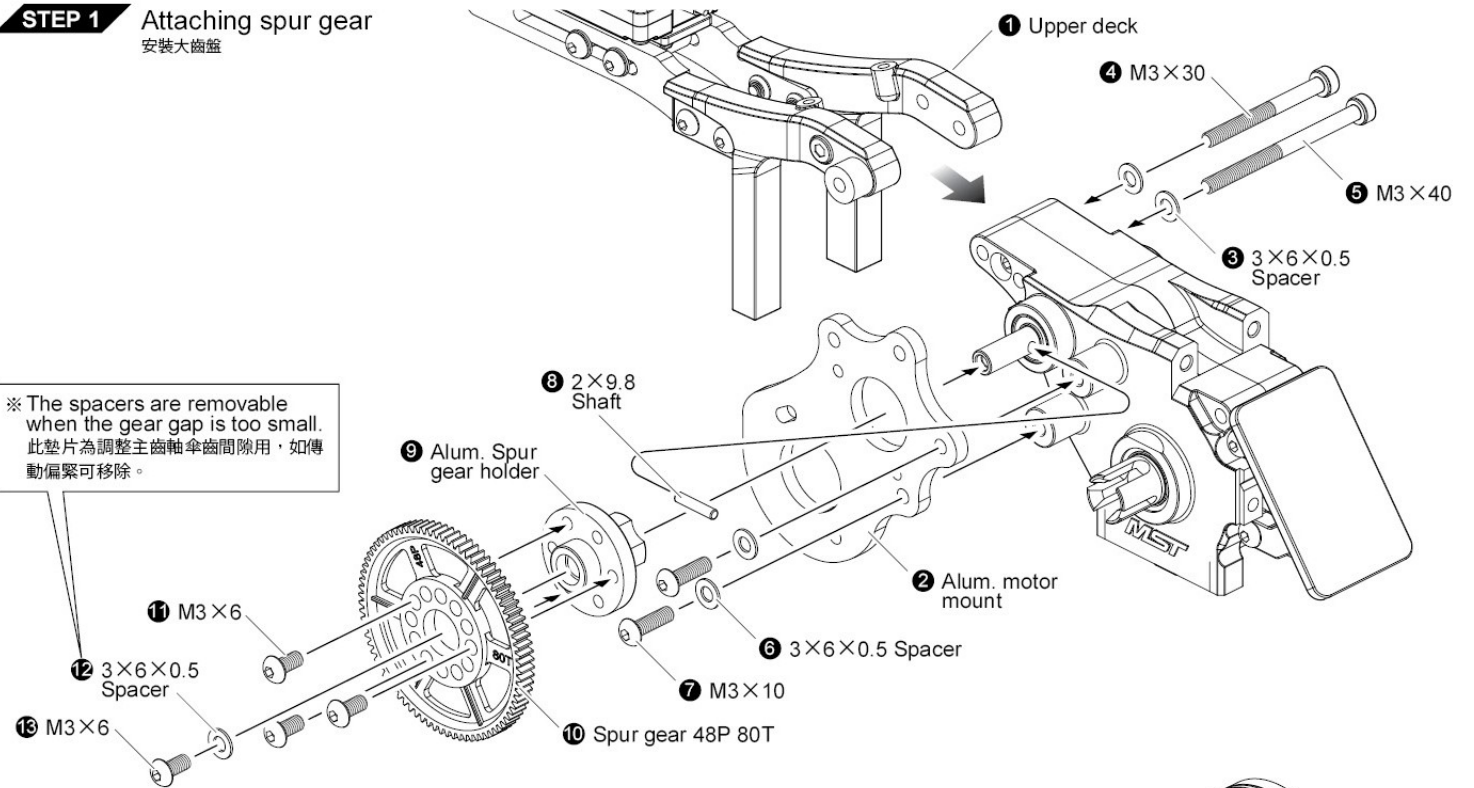

STEP 2 Attaching motor
安裝馬達

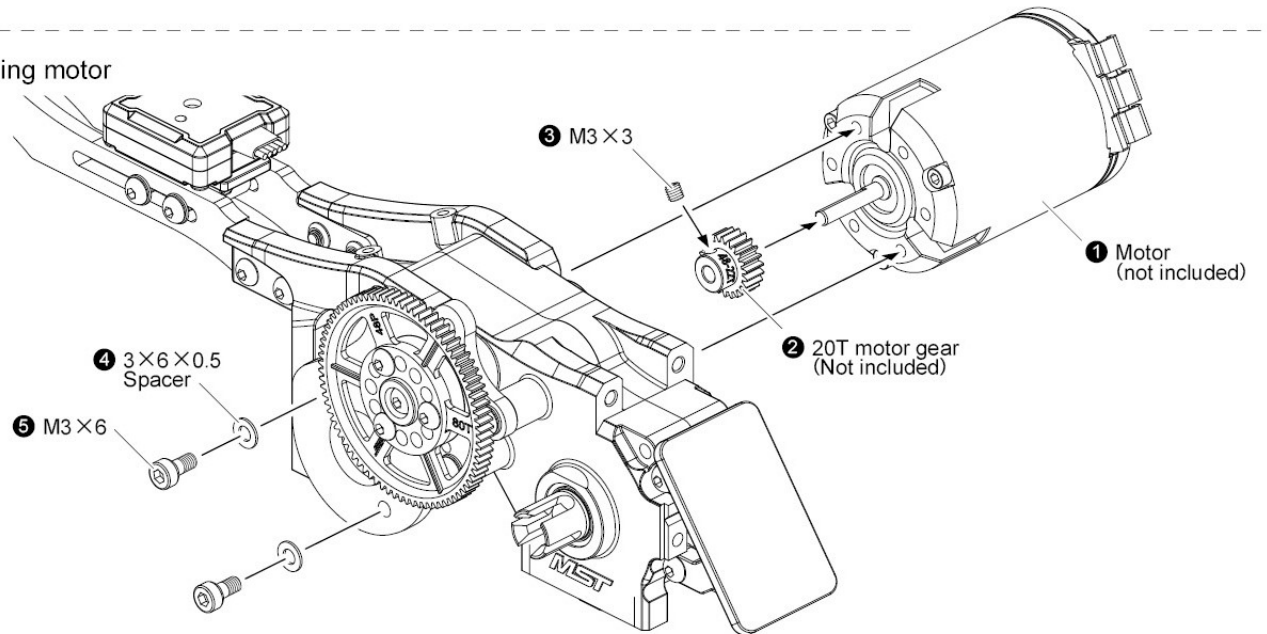

STEP 3

Attaching rear gear box
安裝後齒箱

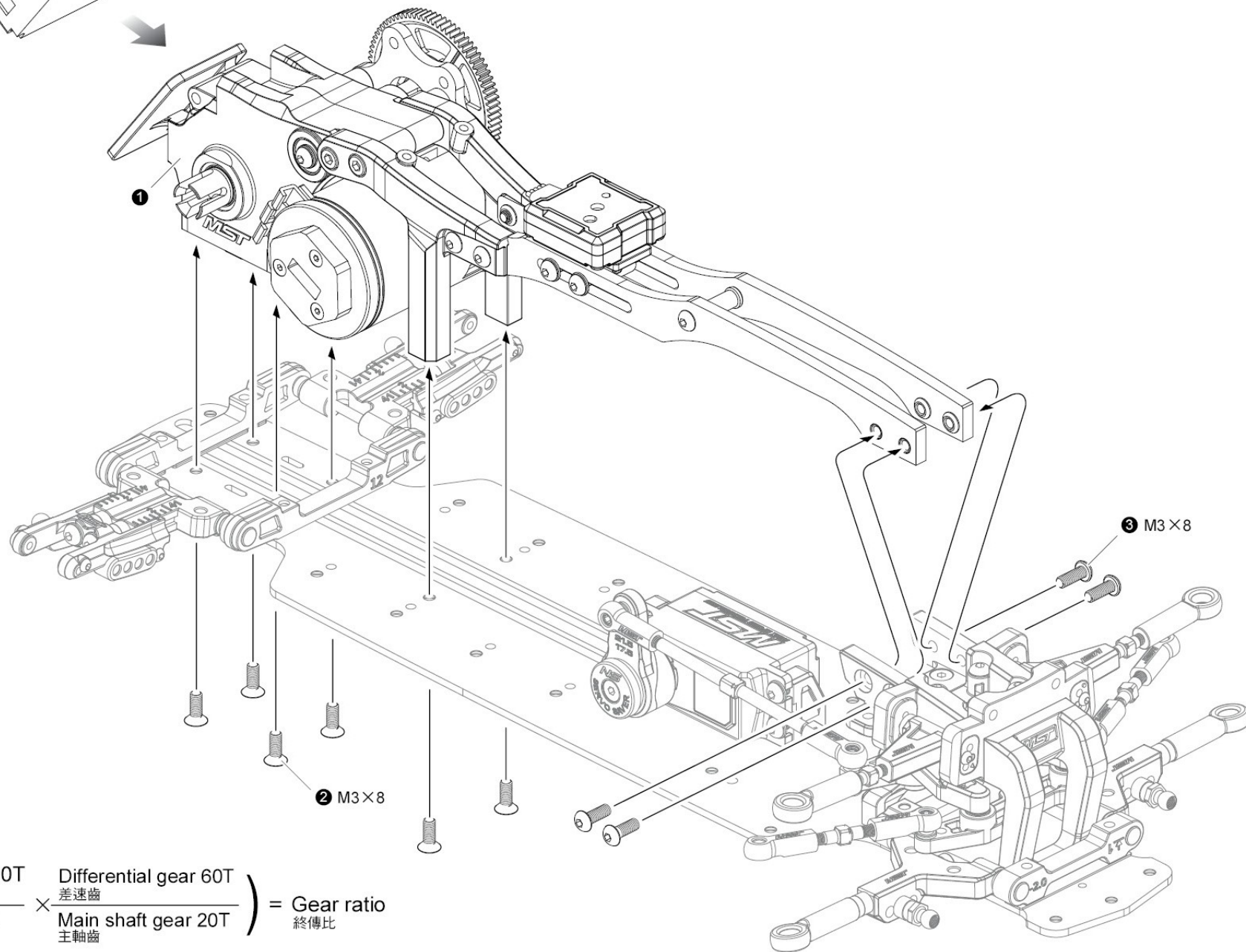
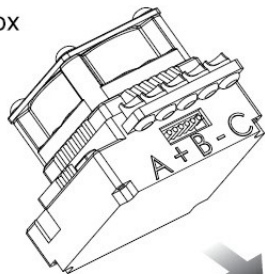

GEAR RATIO (For 80T Spur Gear)	
Pinion gear teeth	60T/20T <3.00>
20T	12
21T	11.43
22T	10.91
23T	10.43
24T	10
25T	9.6
26T	9.23
27T	8.89
28T	8.57
29T	8.28
30T	8
31T	7.74

※ Adjust for proper space.
請調整適當齒隙。

※ **FORMULA** 計算公式

$$\left(\frac{\text{Spur gear teeth 80T}}{\text{Pinion gear teeth}} \right) \times \left(\frac{\text{Differential gear 60T}}{\text{Main shaft gear 20T}} \right) = \text{Gear ratio}$$

大直齒 馬達齒 差速齒 主軸齒 終傳比

STEP 1 Attaching front damper stay
安裝前避震架

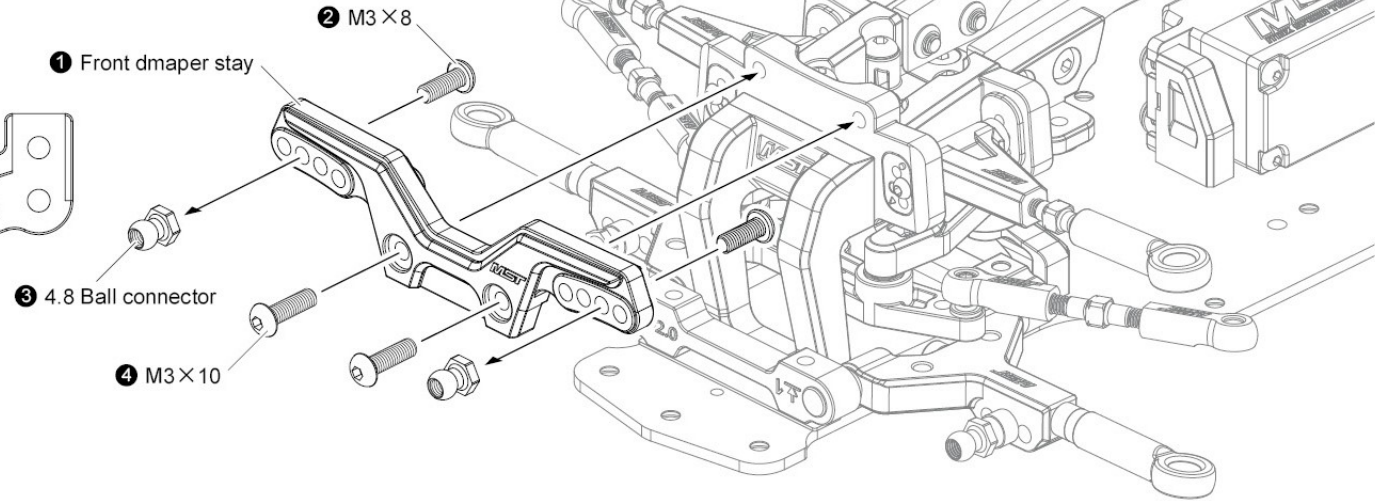
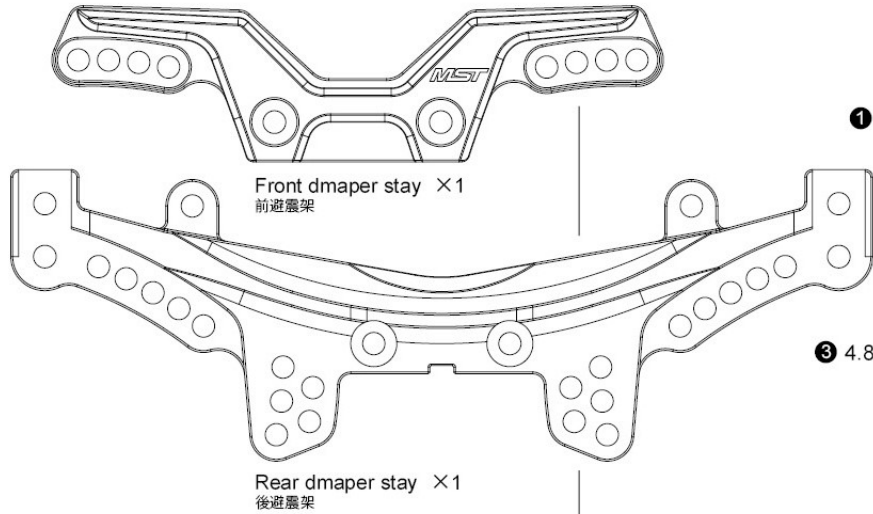

STEP 2 Attaching rear damper stay
安裝後避震架

3×5.5×2 Spacer ×2
墊片

4.8 Ball connector ×4
外六角球頭

4.8 Ball connectorL ×2
外六角球頭

M3×8 screw ×2
圓頭螺絲

M3×10 screw ×8
圓頭螺絲

M3×28 Alum. turnbuckle ×2
鋁合金可調拉桿

4.8 Adjuster M ×4
拉桿頭

※ Please use a caliper for precise measurements.
請使用卡尺進行精確測量

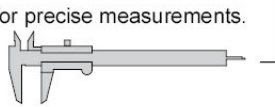

Rear upper turnbuckle assembly
後上拉桿組裝

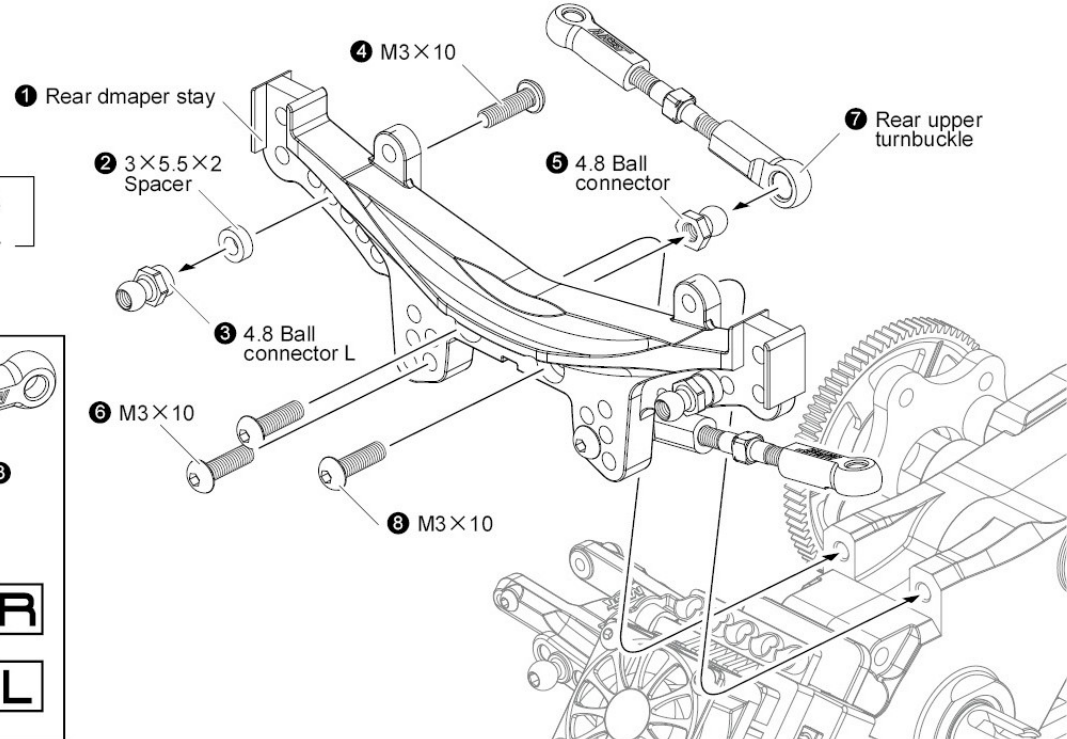
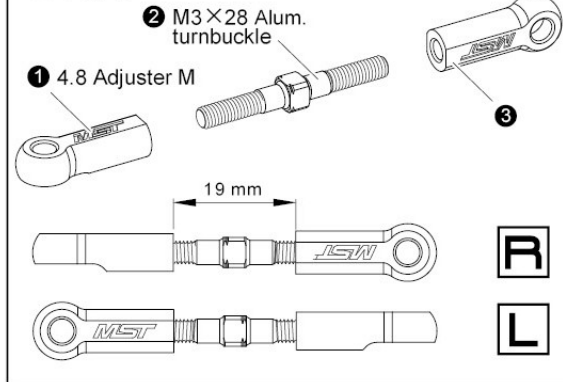

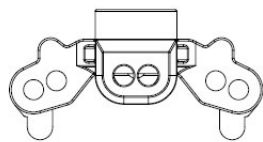

Front upright ×2
前輪座

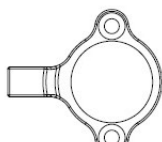

Brake calipers mount ×2
制車卡鉗座



Brake calipers ×2
制車卡鉗

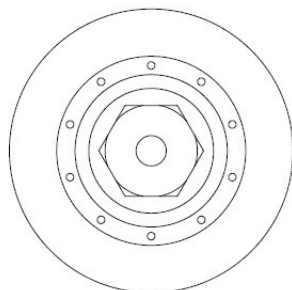

Wheel hubs (large)
(brake disc shaped) ×2
六角輪座(大)(制車碟型)



Wheel hubs ×2
六角輪座



2WD Axle ×2
二驅輪軸



5.8×6 Ball connector L ×4
球頭螺絲(長)



4.8×4.5 Ball connector ×2
球頭螺絲



3×5.5×2 Spacer ×4
墊片

Bag 2



M2×4 screw ×2
圓頭螺絲



M2×6 screw ×2
沉頭螺絲



2×9.8 Shaft ×2
插銷



5×8 Ball bearing ×4
培林



5×7×0.3 Spacer ×2
墊片

STEP 1 Front axle assembly
前輪座組裝

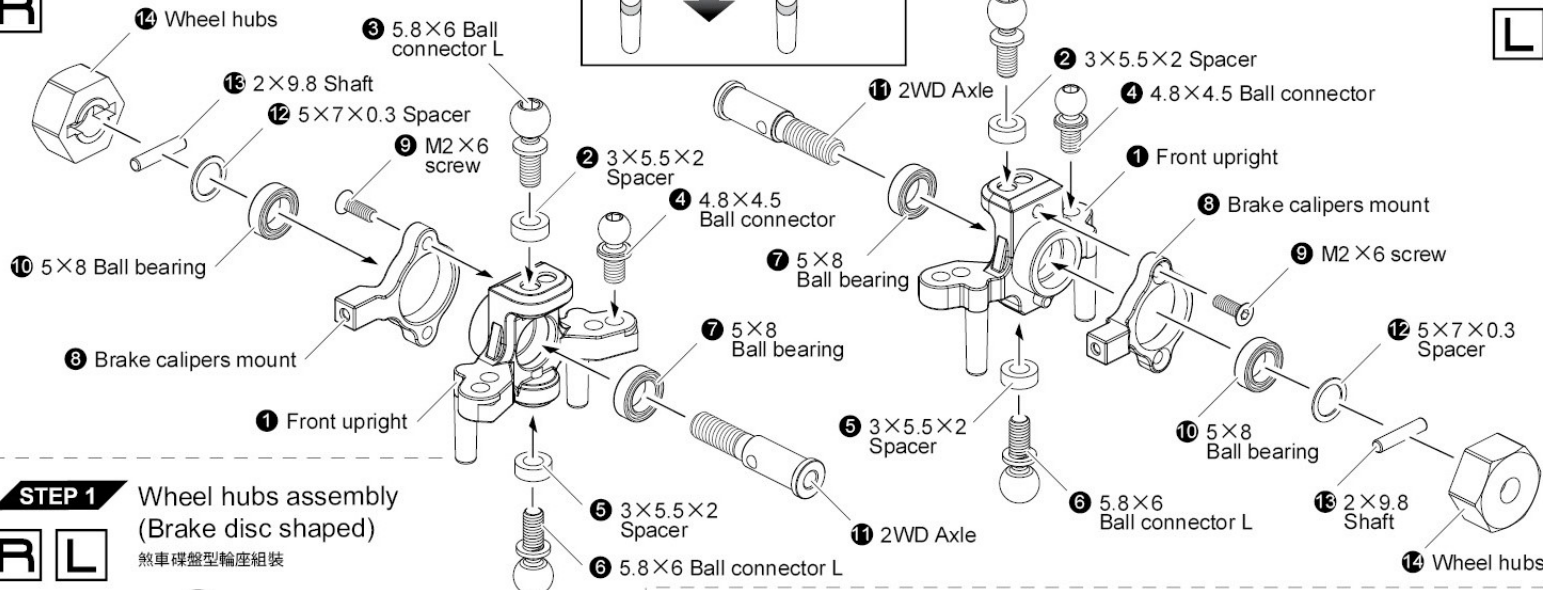

STEP 1 Wheel hubs assembly
(Brake disc shaped)
煞車碟盤型輪座組裝

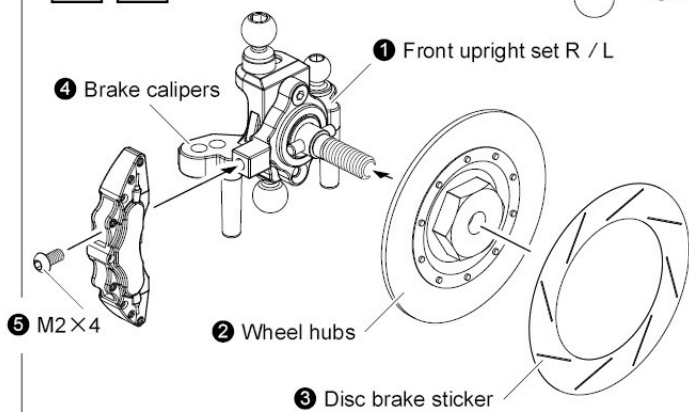

STEP 2 Attaching front axle
安裝前輪座

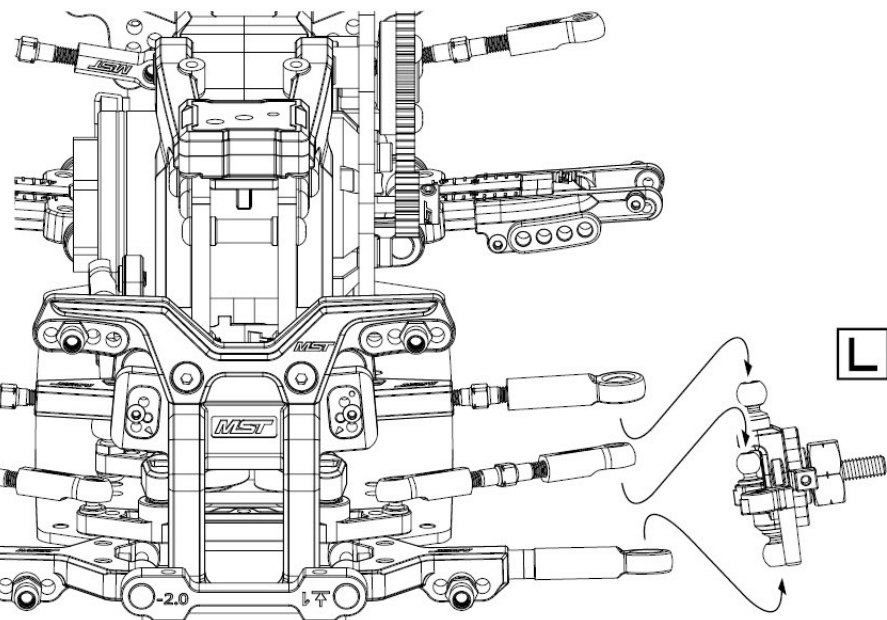

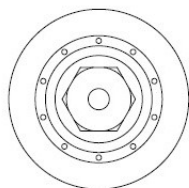

Wheel hubs (small) (brake disc shaped) ×2
六角輪座(小)(剎車碟型)

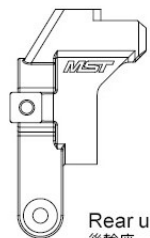

Rear upright ×2
後輪座



Steel CVD universal shaft 38.5 ×2
鋼製CVD傳動軸 38.5



Wheel axle ×2
萬向接杆



2×22 Shaft ×2
插銷



4.8 Ball connector L ×2
外六角球頭(長)



Wheel hubs ×2
六角輪座



Brake calipers ×2
剎車卡鉗

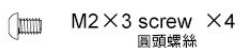

M2×3 screw ×4
圓頭螺絲

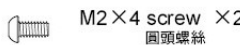

M2×4 screw ×2
圓頭螺絲

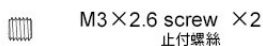

M3×2.6 screw ×2
止付螺絲

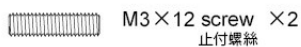

M3×12 screw ×2
止付螺絲

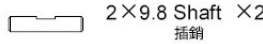

2×9.8 Shaft ×2
插銷

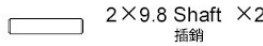

2×9.8 Shaft ×2
插銷

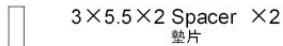

3×5.5×2 Spacer ×2
墊片

Bag 1



Cross joint ×2
連接軸

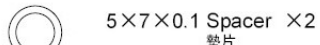

5×7×0.1 Spacer ×2
墊片



5×10 Ball bearing ×4
培林

STEP 1 Rear axle assembly
後輪座組裝

X2
Make 2

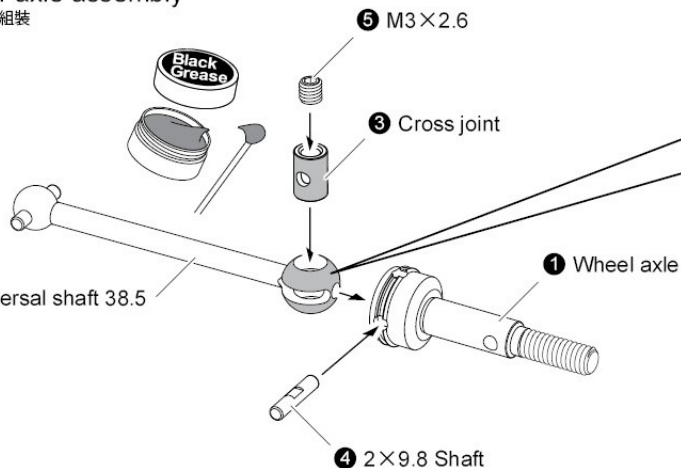

※ Please tighten set screw M3 on the flat.

STEP 2

R

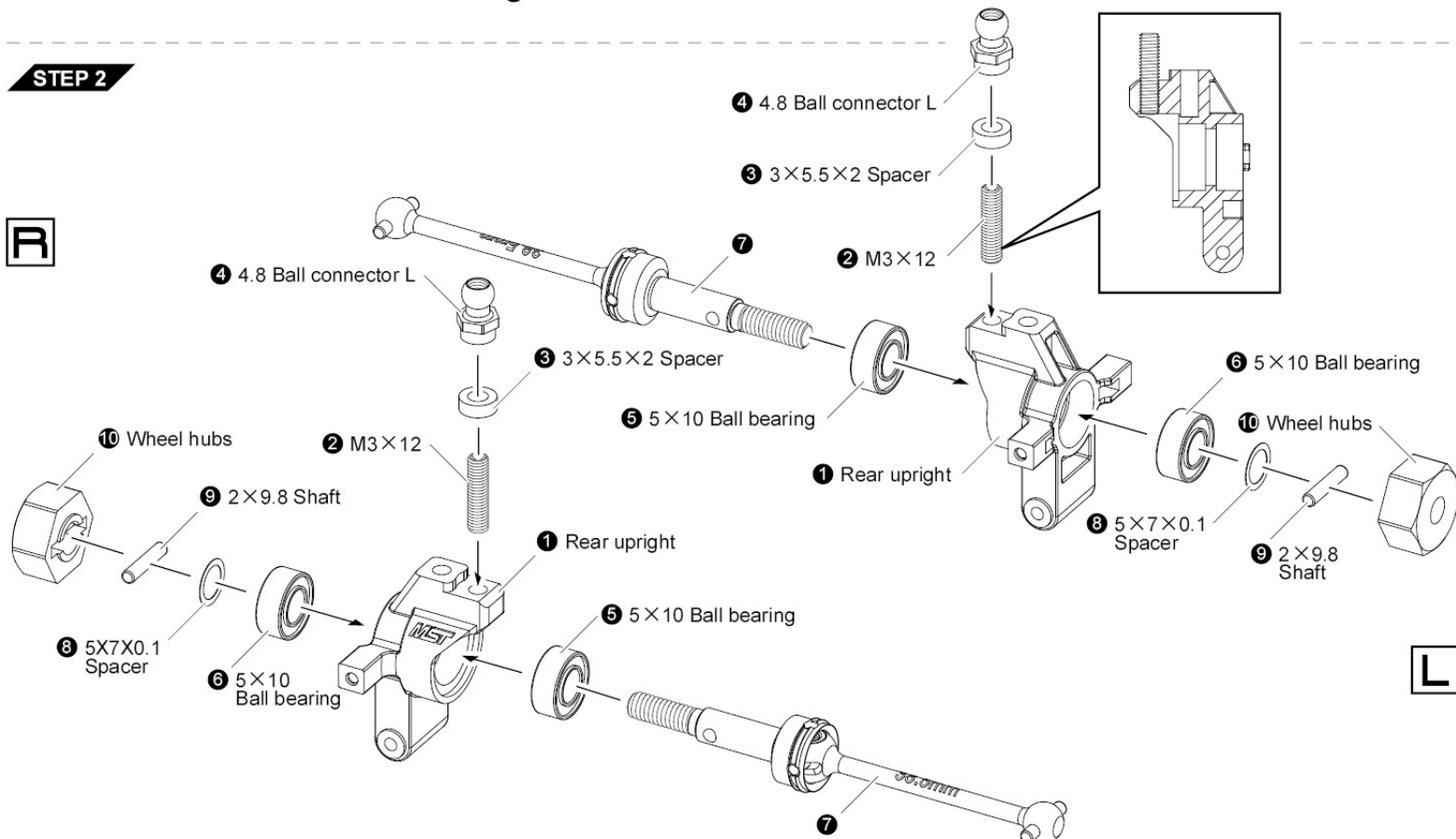

L